

REMOVAL

Transmission

Special Tool(s)

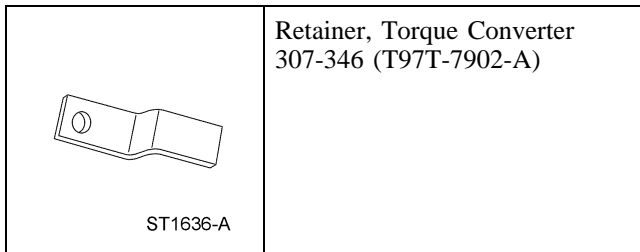

All vehicles

⚠ WARNING: Secure the transmission to the transmission jack with a safety chain. Failure to follow these instructions can result in personal injury.

NOTE: When the battery has been disconnected and reconnected, some abnormal drive symptoms can occur while the vehicle relearns its adaptive strategy. The customer needs to be notified that they can experience slightly different upshifts (either soft or firm) and that this is a temporary condition and will eventually return to normal operating condition.

NOTE: If transmission disassembly or installation of a new transmission is necessary, drain the transmission fluid. Install the drain plug when finished.

NOTE: If the transmission is to be removed for an extended period of time, support the engine with a safety stand and a word block.

1. With the vehicle in NEUTRAL, position it on a hoist. For additional information, refer to Section 100-02.
2. Disconnect the battery ground cable. For additional information, refer to Section 414-01.
3. Remove the complete exhaust system and front heat shields. For additional information, refer to Section 309-00.
4. Remove the driveshaft. For additional information, refer to Section 205-01.

5. **⚠ WARNING:** Secure the transmission to the transmission jack with a safety chain. Failure to follow these instructions may result in personal injury.

Using a suitable transmission jack, support the transmission.

6. Disconnect the heated oxygen sensor (HO2S) connectors and retaining clip from the RH pan rail and then position the connectors aside.

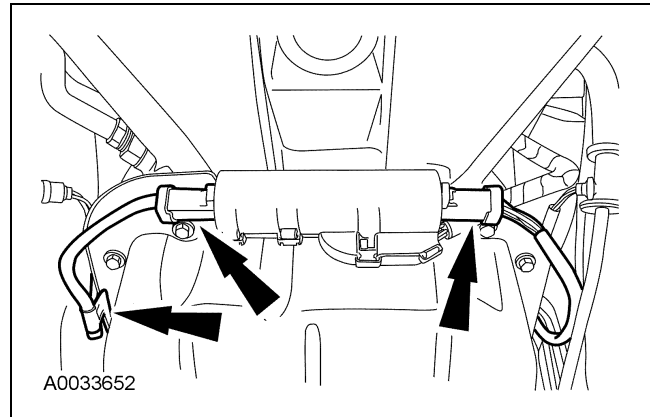

7. Remove the HO2S connector from the front of the transmission pan rail.

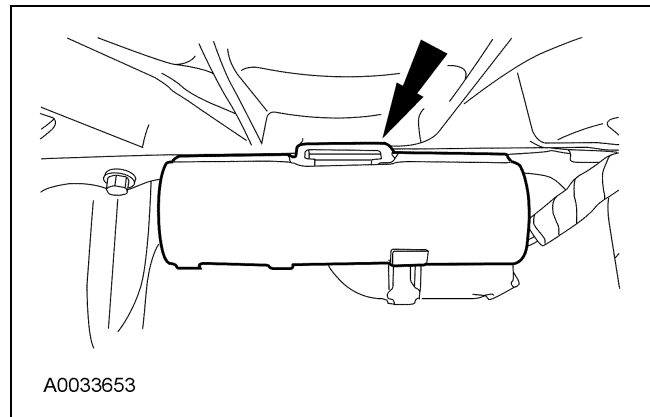

REMOVAL (Continued)

8. Remove the rear transmission crossmember-to-floor pan screws.

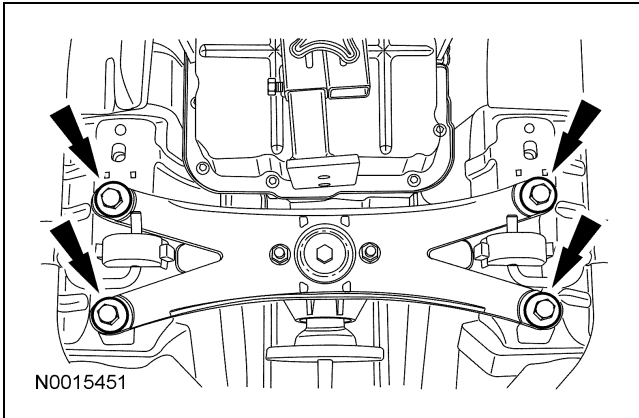

9. Remove the rear transmission insulator-to-extension housing center screw and remove the transmission crossmember.

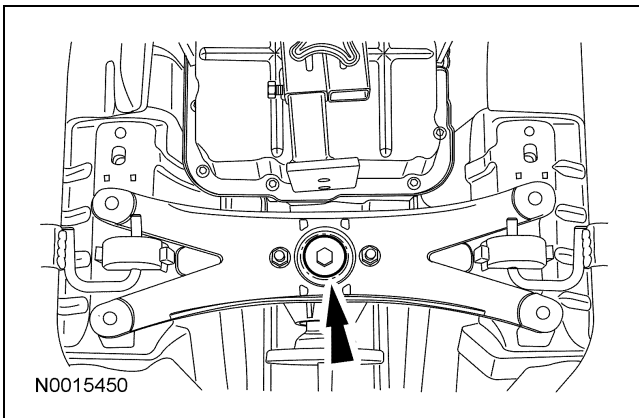

10. Remove the shift cable and bracket and position out of PARK.

- 1 Disconnect the cable from the lever.
- 2 Position the manual lever out of PARK.
- 3 Remove the bolts and the shift cable and bracket and position aside.

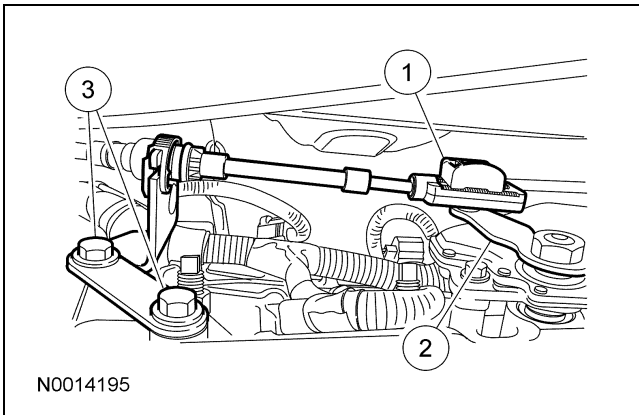
**4.6L engine**

11. Remove the electrical connector cover.

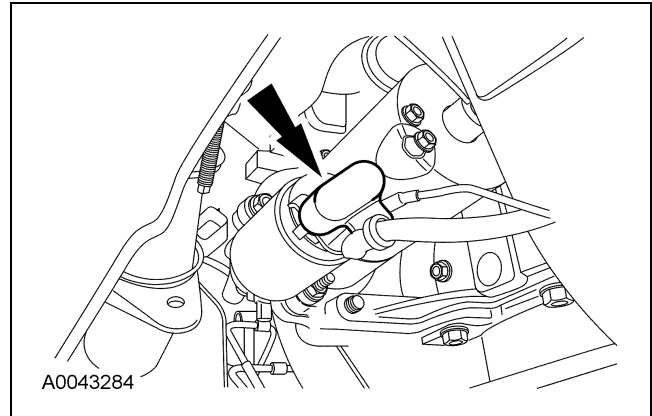

12. Remove the starter wire and positive battery cable.

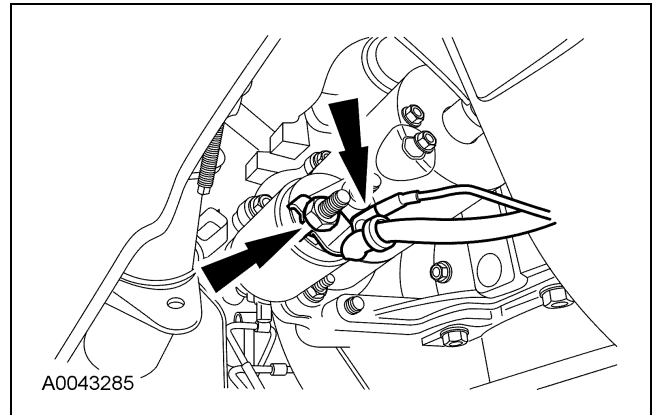

13. Remove the starter motor bolts and starter.

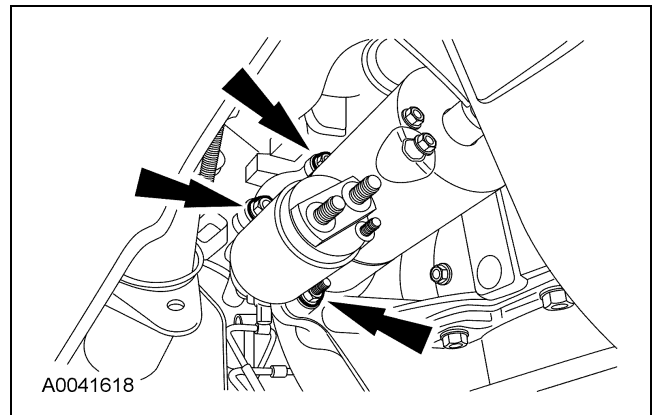

REMOVAL (Continued)

14. Remove the flexplate cover.

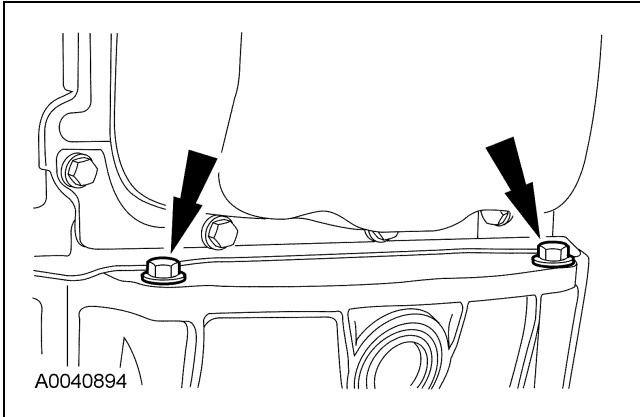

15. Remove the access cover.

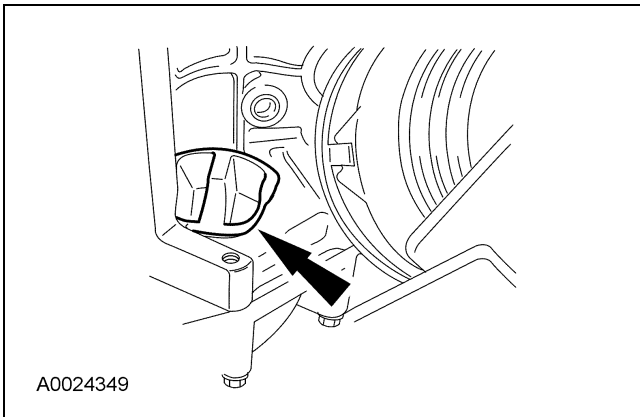

16. Remove the 4 torque converter nuts.

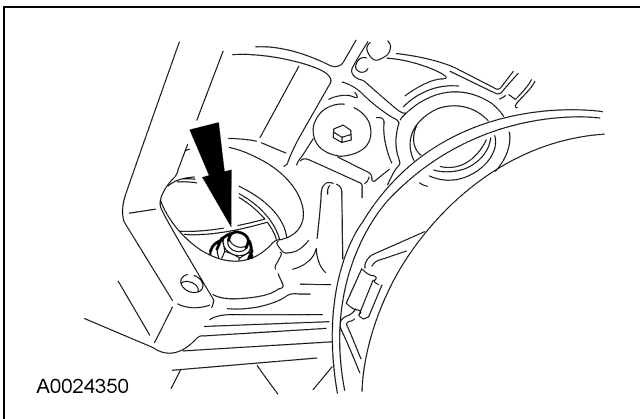

4.0L engine

17. Remove the starter and position aside.

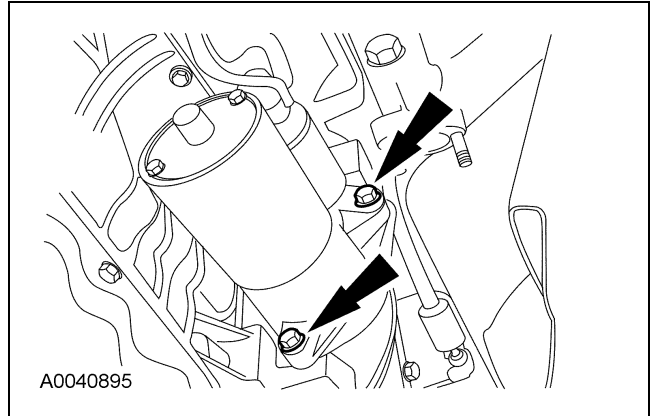

18. Remove the 4 torque converter nuts.

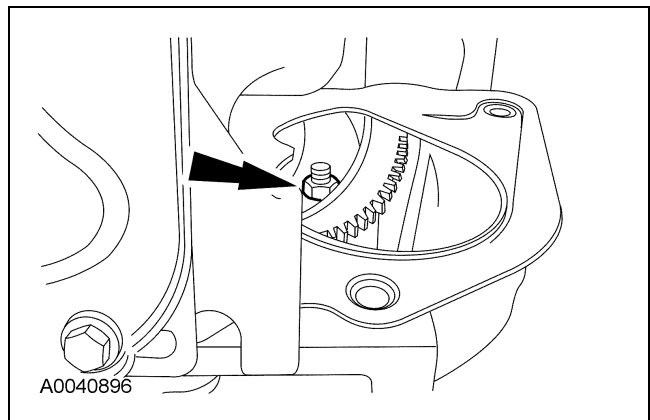

19. Remove the lower transmission retaining bolts.

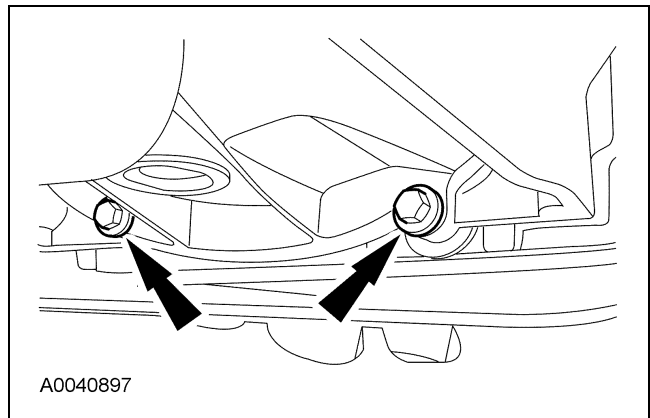

20. Lower the transmission to gain access to the sensor connectors and the transmission bolts.

REMOVAL (Continued)

21. Disconnect the digital transmission range (TR) sensor connector.

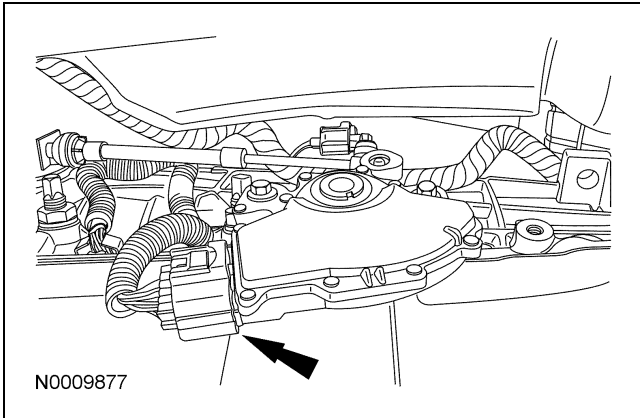

24. Disconnect the harness retainers.

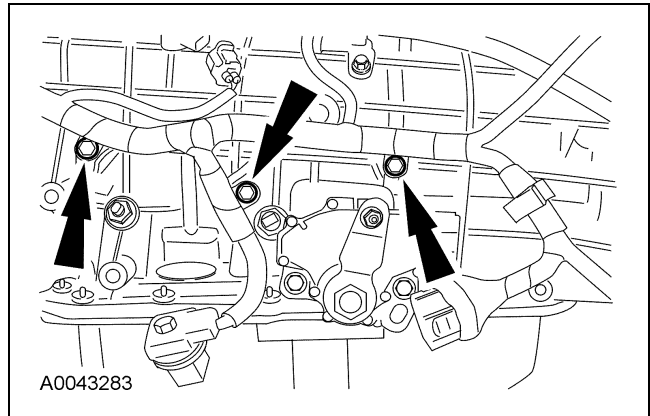

22. Disconnect the turbine shaft speed (TSS) sensor, output shaft speed (OSS) sensor and intermediate shaft speed (ISS) sensor electrical connectors.

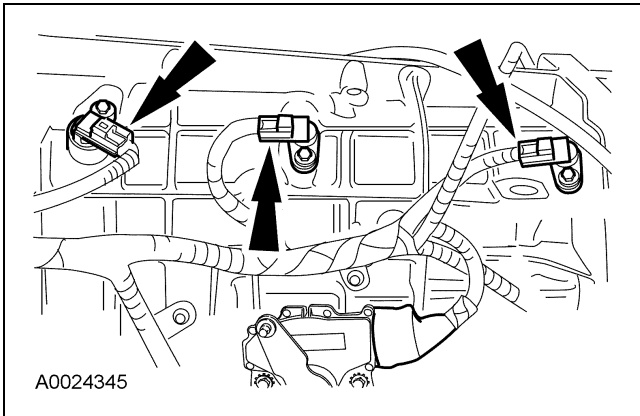

All vehicles

25. **⚠ CAUTION: Do not damage the cooler tubes.**

Disconnect the transmission cooler tubes.

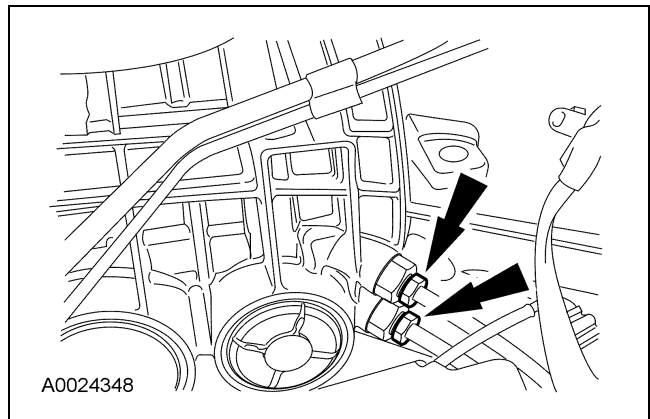

23. **NOTE:** Clean the area around the connector to prevent contamination of the solenoid body connector.

Remove the screw from the solenoid body connector and disconnect the connector.

4.6L engine

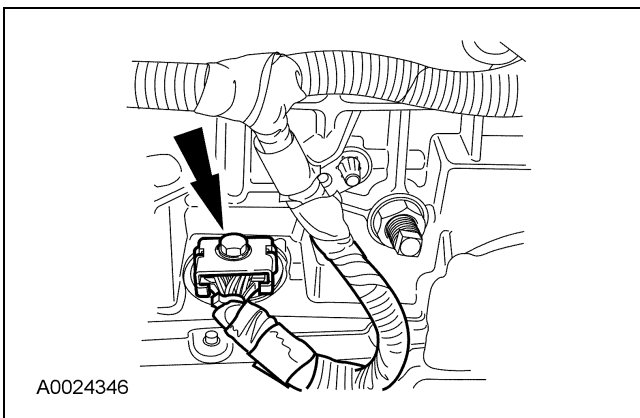

26. Remove the 7 engine-to-transmission retaining bolts.

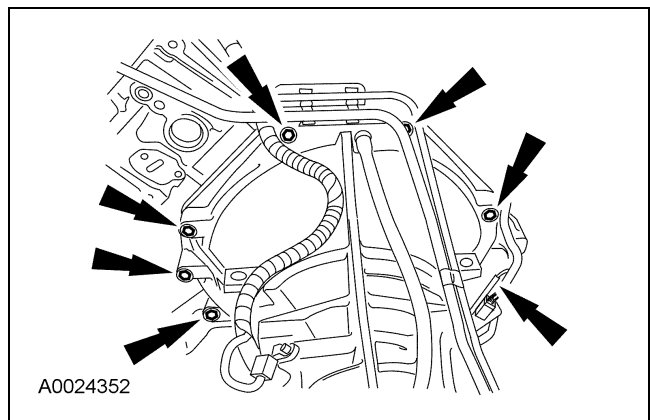

REMOVAL (Continued)**4.0L engine**

27. Remove the 6 engine-to-transmission retaining bolts and position the fuel line bracket aside.

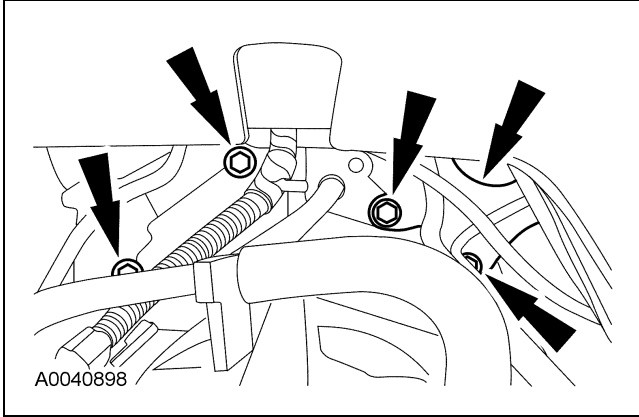
**All vehicles**

28. Lower the transmission assembly from the vehicle.

29. Install the special tool.

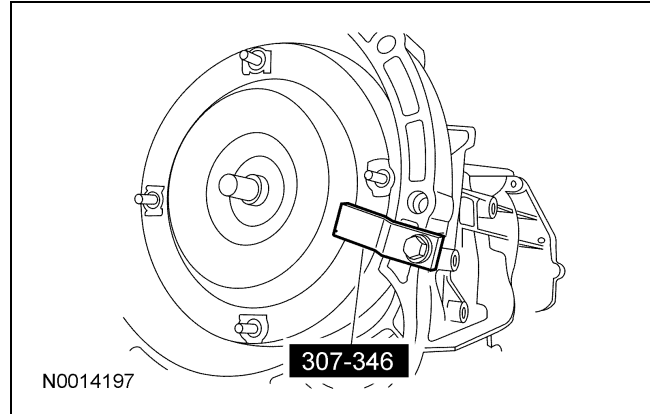

30. Carry out the transmission fluid cooler backflushing and cleaning if the transmission is being overhauled or installing a new or remanufactured transmission. For additional information, refer to Transmission Fluid Cooler — Backflushing and Cleaning in this section.