

REMOVAL AND INSTALLATION

Spring — Coil

Special Tool(s)

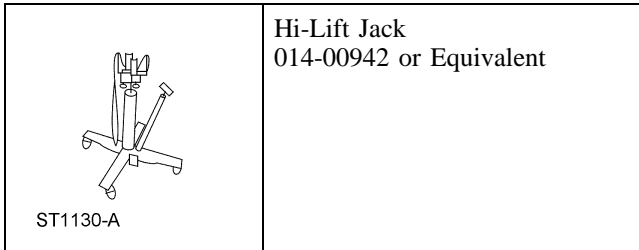

Removal and Installation

⚠ CAUTION: Suspension fasteners are critical parts because they affect performance of vital parts and systems and their failure can result in major service expense. A new part with the same part number must be installed if installation becomes necessary. Torque values must be used as specified during reassembly to make sure of correct retention of these parts.

All vehicles

1. Mark the rear shock absorber relative to the protective sleeve with the vehicle in a static, level ground position (curb height).

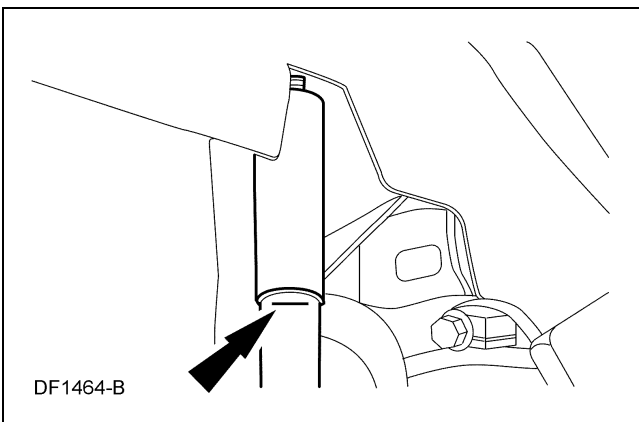

2. With the vehicle in NEUTRAL, position it on a hoist. For additional information, refer to Section 100-02.
3. Using the special tool, support the rear axle.

Vehicles with a rear stabilizer bar

4. Remove and discard both stabilizer bar link bolts and nuts.
 - To install, tighten to 115 Nm (85 lb-ft).

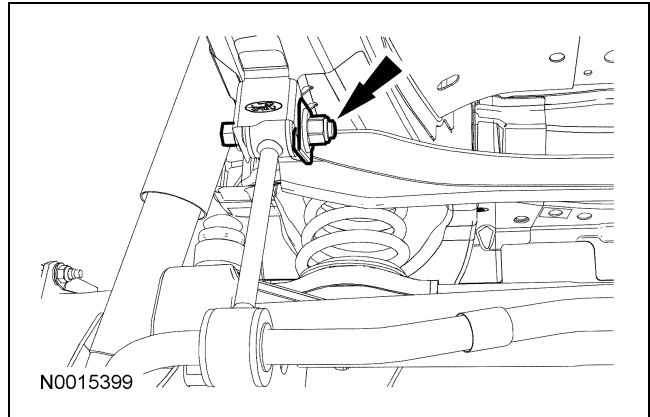

5. Position the stabilizer bar to gain access to the shock absorber lower bolt.

All vehicles

6. **NOTE:** Tighten the shock absorber lower bolt while the suspension is at curb height. Remove and discard the shock absorber lower bolt and nut.
 - To install, tighten to 115 Nm (85 lb-ft).

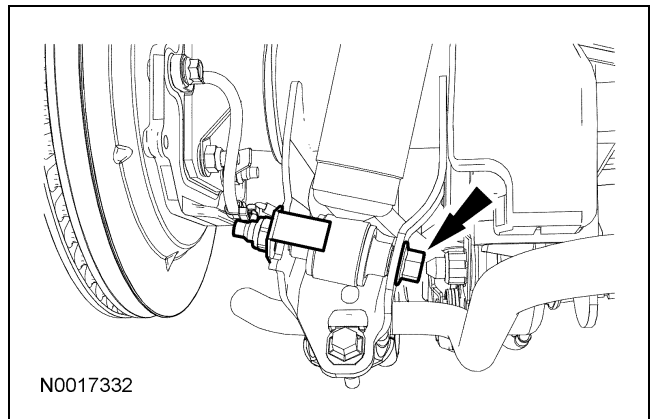

7. Remove the brake hose bracket bolt.
 - To install, tighten to 20 Nm (15 lb-ft).
8. Using the special tool, lower the rear axle and remove the spring.

REMOVAL AND INSTALLATION (Continued)

9. Inspect the upper and lower spring insulators for wear or damage. Install new insulators if necessary.
10. Using the special tool, raise the rear axle so the mark made on the rear shock absorber in Step 1 lines up with the protective sleeve.

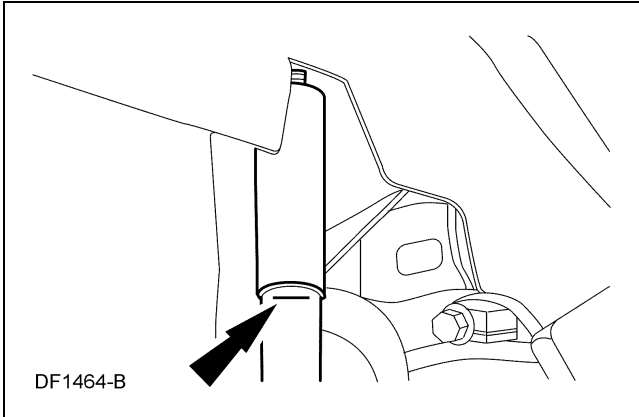

11. To install, reverse the removal procedure.
 - Always install new fasteners.

12. **NOTE:** The springs are vehicle specific and are marked with a tag indicating the spring code. Make sure the new spring has the same spring code as the one being replaced. If the tag is not on the spring being replaced, look on the vehicle information label located on the driver's door for the spring code and compare that to the new spring code.

When installing a new spring, install the spring with the tag toward the axle assembly.

