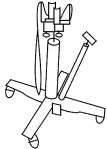

REMOVAL AND INSTALLATION

Lower Arm

Special Tool(s)

 <p>ST1130-A</p>	<p>Hi-Lift Jack 014-00942 or equivalent</p>
---	---

Removal and Installation

⚠ CAUTION: Suspension fasteners are critical parts because they affect performance of vital parts and systems and their failure can result in major service expense. A new part with the same part number must be installed if installation becomes necessary. Torque values must be used as specified during reassembly to make sure of correct retention of these parts.

1. Mark the rear shock absorber relative to the protective sleeve with the vehicle in a static, level ground position (curb height).

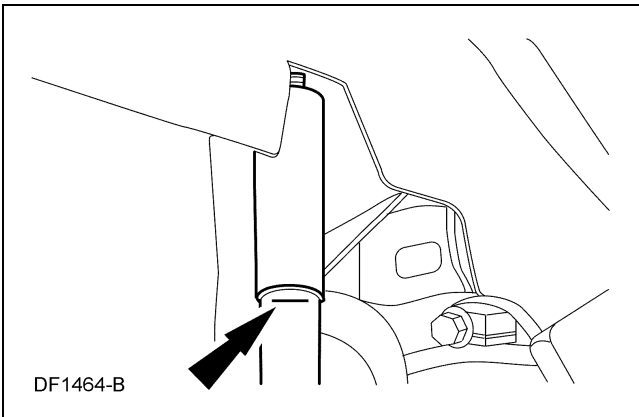

2. With the vehicle in NEUTRAL, position it on a hoist. For additional information, refer to Section 100-02.
3. Remove the wheel and tire assemblies. For additional information, refer to Section 204-04.
4. Remove the parking brake cable from the rear caliper.
 - 1 Remove the clip.
 - 2 Disconnect the parking brake cable.

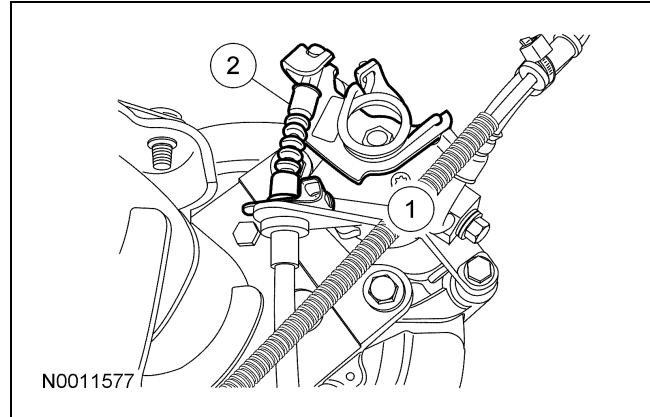

5. Remove the parking brake cable bracket.
 - To install, tighten the bolt to 35 Nm (26 lb-ft).

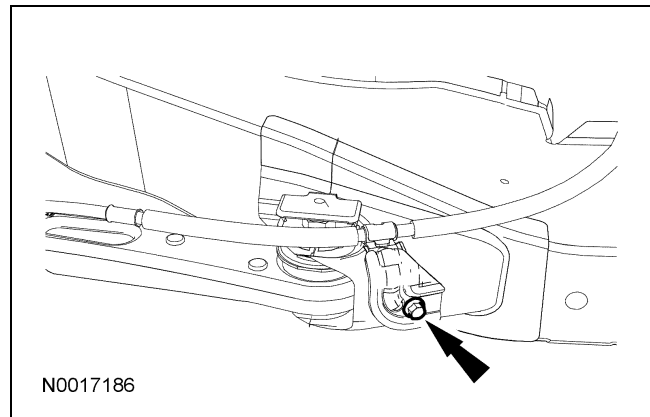

6. **⚠ CAUTION: Do not support the rear axle at the differential housing.**
Support the rear axle with a jack stand.

REMOVAL AND INSTALLATION (Continued)

7. **NOTE:** Tighten the lower arm bolts while the suspension is at curb height.

Remove and discard the lower arm front bolt.

- To install, tighten to 175 Nm (129 lb-ft).

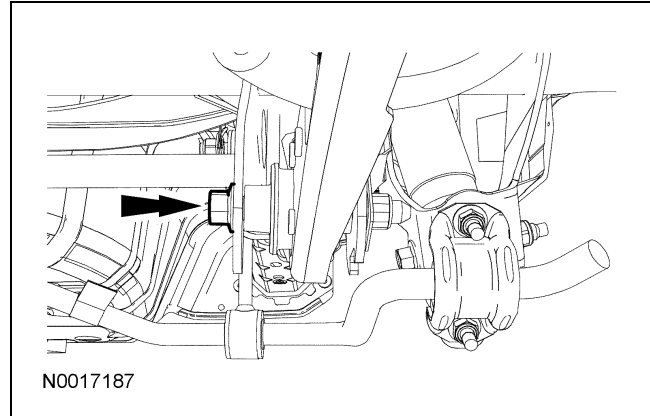
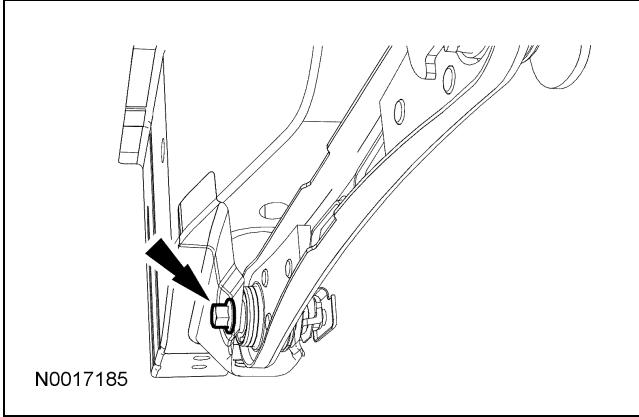

8. Remove and discard the lower arm front nut.

- 1 Rotate the nut clockwise.
- 2 Remove the nut.

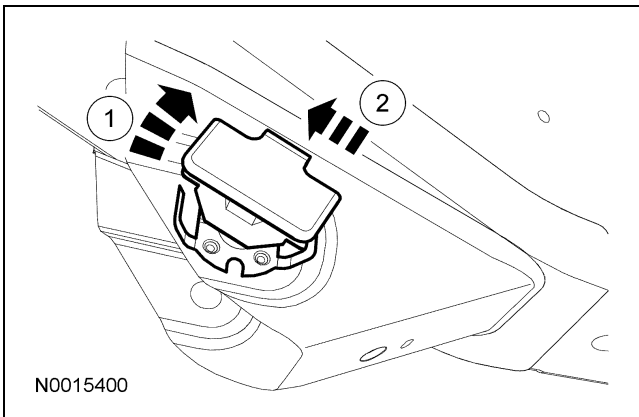

9. **NOTE:** Tighten the lower arm bolts while the suspension is at curb height.

Remove and discard the lower arm rear bolt and flag nut.

- To install, tighten to 175 Nm (129 lb-ft).

10. Remove the lower arm.

11. Using the special tool, raise the rear axle so the mark made on the rear shock absorber in Step 1 lines up with the protective sleeve.

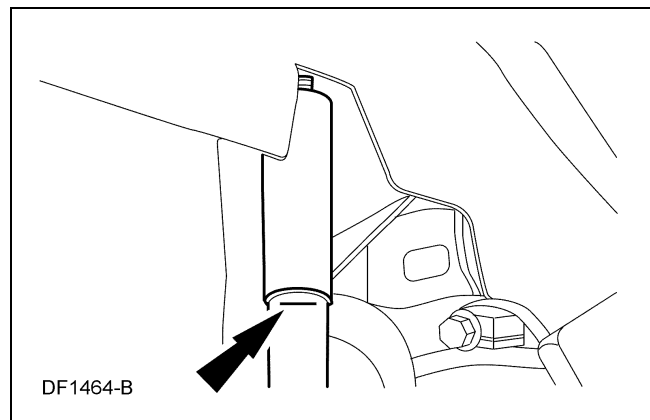

12. **NOTE:** Tighten the lower arm bolts while the suspension is at curb height.

To install, reverse the removal procedure.

- Always install new fasteners.