

REMOVAL AND INSTALLATION

Driveshaft — 4.0L

Material

Item	Specification
Threadlock and Sealer TA-25	WSK-M2G351-A5

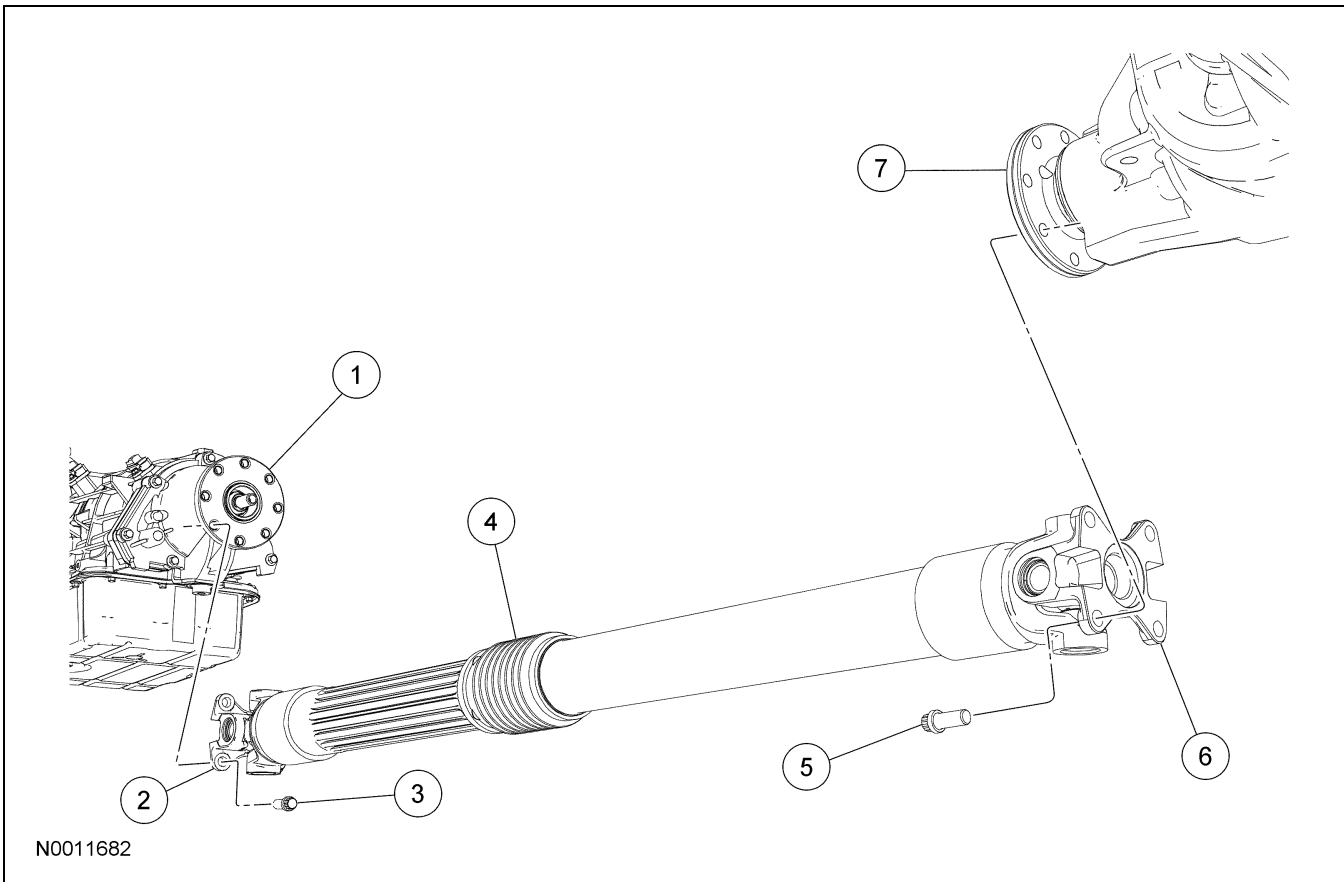

Item	Part Number	Description
1	—	Transmission output flange
2	—	Driveshaft flange (part of 4602)
3	—	Driveshaft flange bolt
4	—	Driveshaft slip yoke boot (part of 4602)
5	—	Driveshaft flange bolt
6	—	Driveshaft flange (part of 4602)

(Continued)

Item	Part Number	Description
7	—	Pinion flange

Removal and Installation

1. With the vehicle in **NEUTRAL**, position it on a hoist. For additional information, refer to Section 100-02.

REMOVAL AND INSTALLATION (Continued)

2. Index-mark the driveshaft to maintain alignment during installation.

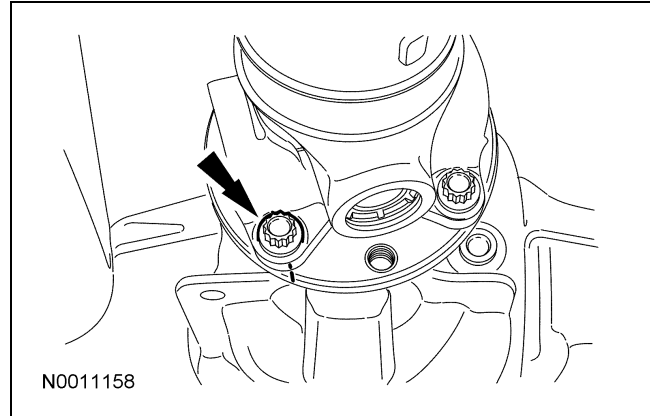
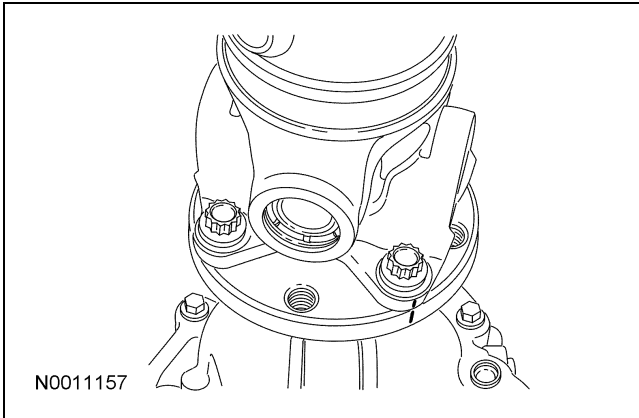

4. **⚠ CAUTION:** The driveshaft flanges fit tightly on the flange pilots. Never hammer on the driveshaft or any of its components to disconnect the driveshaft flanges from the flange pilots. Pry only in the area shown with a suitable tool, to disconnect the driveshaft flanges from the flange pilots.

Using a suitable tool as shown, disconnect the driveshaft flanges from the flange pilots and remove the driveshaft.

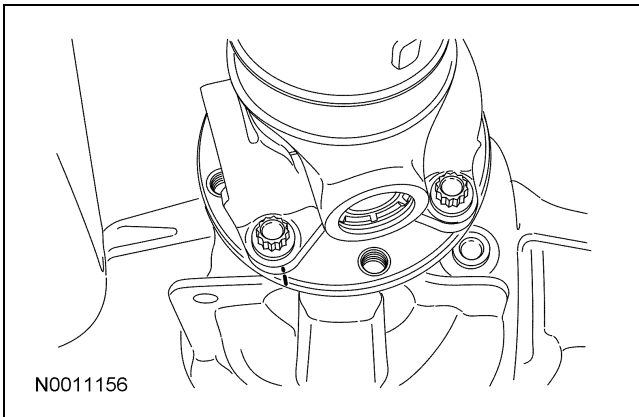

3. Remove and discard the 8 driveshaft flange bolts.
- To install, tighten to 103 Nm (76 lb-ft).

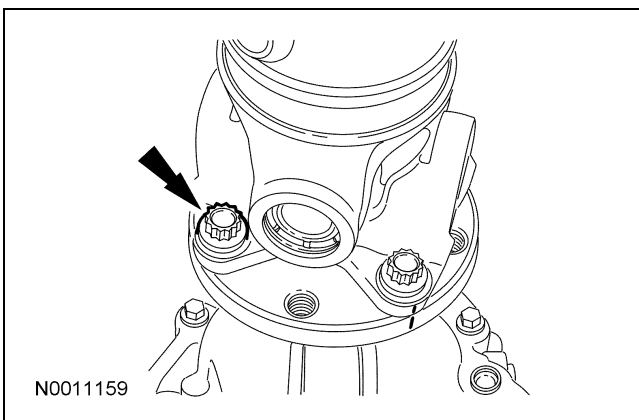
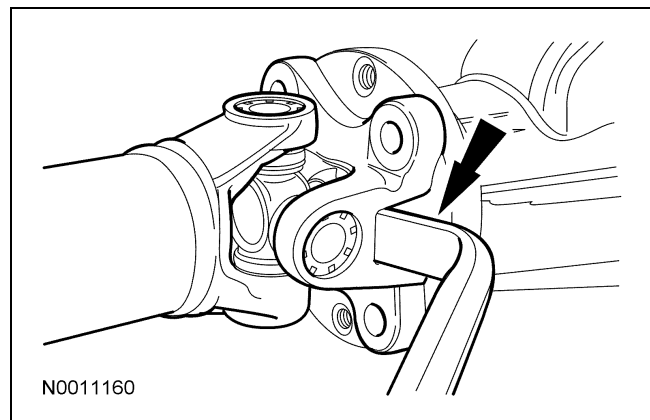

REMOVAL AND INSTALLATION (Continued)

5.  **CAUTION:** The driveshaft flanges fit tightly on the pinion flange pilots. To make sure that the driveshaft flanges seat squarely on the pinion flange pilots, tighten the driveshaft flange bolts evenly in a cross pattern.

 **CAUTION:** If new driveshaft flange bolts are not available, coat the threads of the original driveshaft flange bolts with threadlock and sealer.

To install, reverse the removal procedure.

- Install new fasteners.
-