

### Wheel Speed Sensor — Rear

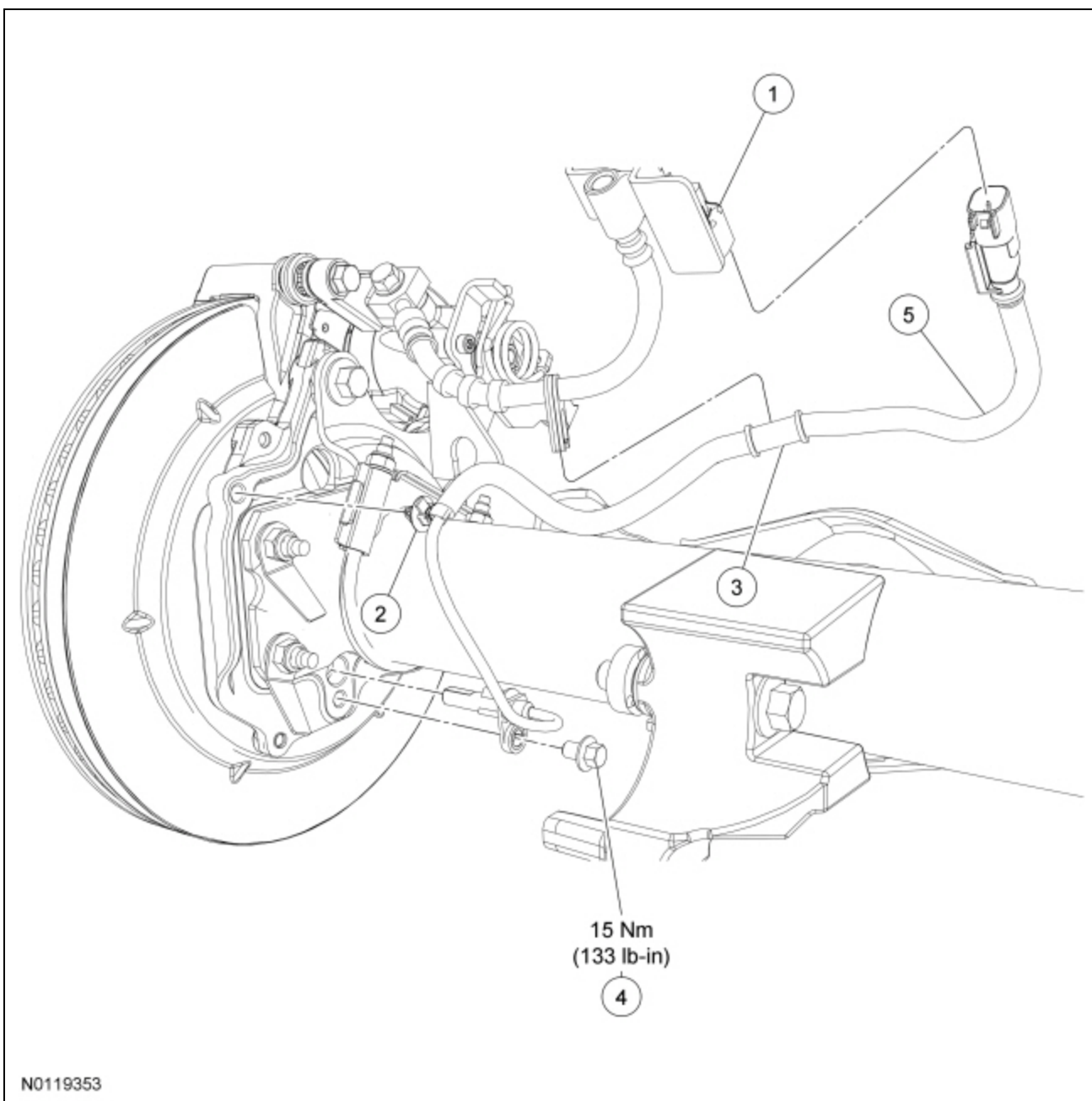

Item	Part Number	Description
1	—	Wheel speed sensor electrical connector (part of 14407)
2	—	Wheel speed sensor harness pin-type retainer (part of 2C190)
3	—	Wheel speed sensor grommet (part of 2C190)
4	W500020	Wheel speed sensor bolt
5	2C190	Wheel speed sensor

#### Removal and Installation

1. With the vehicle in NEUTRAL, position it on a hoist. For additional information, refer to [Section 100-02](#).
2. **NOTE:** If the wheel speed sensor is disconnected with the ignition in the ACC or RUN position, a DTC will be set in the ABS module.

Turn the ignition to the OFF position.

3. Disconnect the wheel speed sensor electrical connector.
4. Disconnect the 2 wheel speed sensor harness pin-type retainers.
5. Disconnect the wheel speed sensor grommet from the brake hose clip.
6. Remove the wheel speed sensor bolt.
  - To install, tighten to 15 Nm (133 lb-in).
7. Remove the wheel speed sensor.
8. To install, reverse the removal procedure.