

N0124049

Item	Part Number	Description
1	9430	RH Exhaust manifold
2	6051	RH cylinder head gasket
3	6049	RH cylinder head
4	N807352	Primary timing chain tensioner bolt (4 required)
5	6L266	Primary timing chain tensioner (2 required)
6	6G004	Cylinder Head Temperature (CHT) sensor
7	6B288	Camshaft Position (CMP) sensor (2 required)
8	W503277	CMP sensor bolt (2 required)
9	W503277	Radio capacitor bolt (2 required)
10	18801	Radio capacitor (2 required)
11	12K073	Camshaft transducer (2 required)
12	6065	Cylinder head bolt (20 required)
13	18696	Heater supply tube
14	W503277	Heater supply tube bolt

15	6250	RH exhaust camshaft
16	6C683	Camshaft engine oil filter (4 required)
17	6250	RH intake camshaft
18	6582	RH valve cover
19	6766	Oil filler cap
20	6A666	PCV valve
21	6578	Crankcase vent hose
22	12405	Spark plug (8 required)
23	12029	Ignition coil on plug (8 required)
24	W714507	Ignition coil on plug bolt (8 required)
25	12A581	Engine wiring harness
26	W714866	Throttle Body (TB) bolt (4 required)
27	9F991	<u>TB</u>
28	9F624	Plenum heat control inlet tube
29	W710652	Plenum heat control inlet tube bolt
30	W503278	Fuel vapor purge valve bolt (2 required)
31	9C915	Fuel vapor purge valve
32	9424	Intake manifold
33	9F792	Fuel rail
34	9C995	Fuel injector clip (8 required)
35	9F593	Fuel injector (8 required)
36	W714864	Fuel rail bolt (4 required)
37	6P013	RH fuel injector insulator shield
38	6P013	LH fuel injector insulator shield
39	6762	Crankcase vent valve
40	6582	LH valve cover
41	6754	Oil indicator tube
42	6750	Oil indicator
43	6518	Valve spring retainer key (64 required)
44	6514	Valve spring retainer (32 required)
45	6513	Valve spring (32 required)
46	6571	Valve stem seal (32 required)
47	W714866	Coolant outlet connector bolt (2 required)
48	8594	Coolant outlet connector
49	6250	LH intake camshaft
50	6K297	Secondary tensioner shoe (2 required)
51	6K254	Secondary tensioner (2 required)
52	—	Camshaft bearing cap (part of 6049) (2 required)
53	—	Camshaft bearing cap (part of 6049) (16 required)
54	N806183	Camshaft bearing cap bolt (40 required)
55	6500 /6564	Hydraulic lash adjuster/camshaft roller follower (32 required)
56	6250	LH exhaust camshaft
57	6049	LH cylinder head

58	6268	Secondary timing chain (2 required)
59	6279	Camshaft sprocket bolt (12 required)
60	6256	Intake camshaft Variable Camshaft Timing (VCT) (2 required)
61	6256	Exhaust camshaft <u>VCT</u> (2 required)
62	6505	Exhaust valve (16 required)
63	6051	LH cylinder head gasket
64	6507	Intake valve (16 required)
65	W713604	Exhaust manifold stud (early build-coarse pitch) (16 required)
65	W714869	Exhaust manifold stud (late build-fine pitch) (16 required)
66	9448	Exhaust manifold gasket (2 required)
67	9431	LH exhaust manifold
68	W714964	Exhaust manifold nut (early build-coarse pitch) (16 required)
68	W714870	Exhaust manifold nut (late build-fine pitch) (16 required)

Engine — Lower End

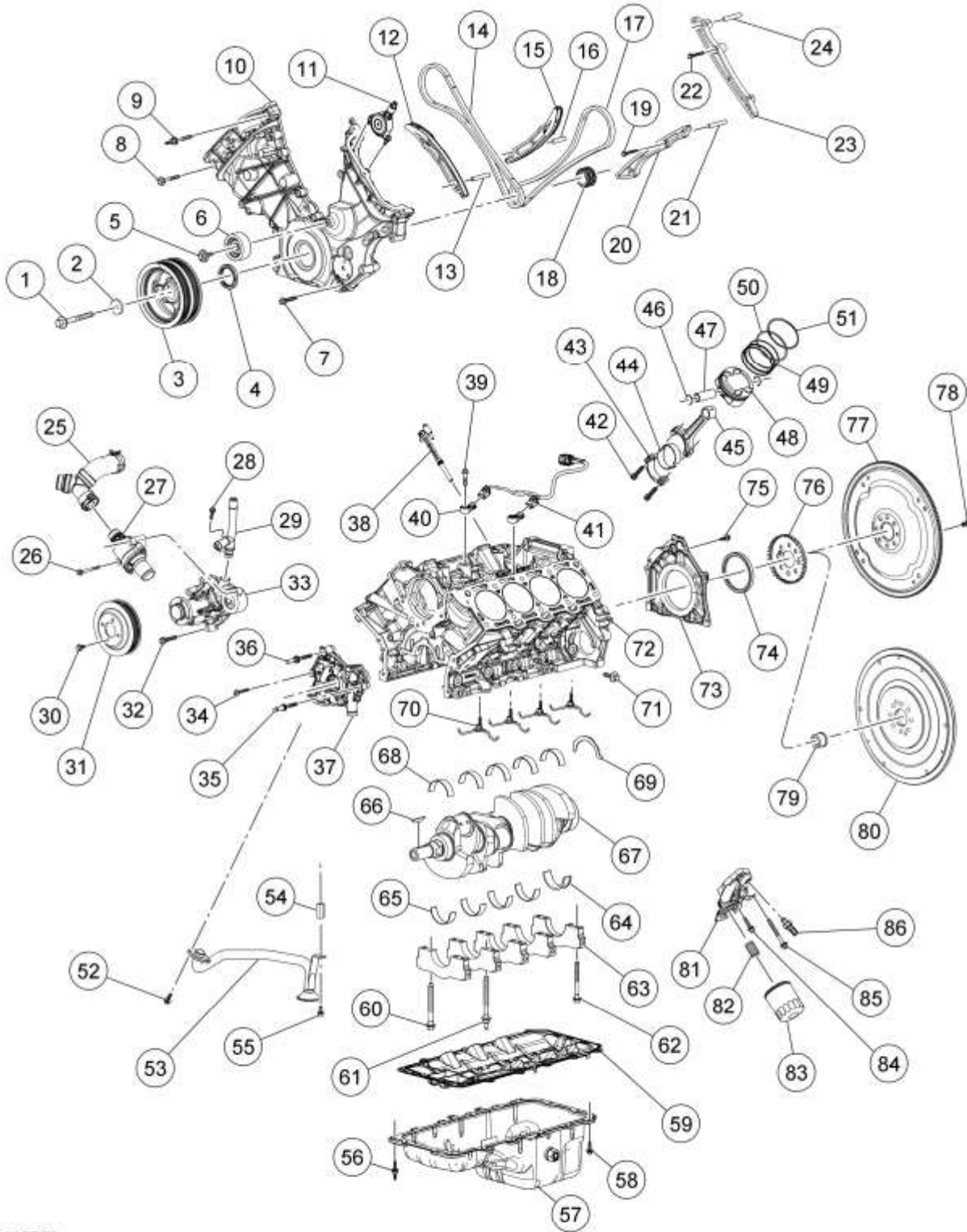

N0115792

Item	Part Number	Description
1	6A340	Crankshaft pulley bolt
2	N807033	Crankshaft pulley washer
3	6316	Crankshaft pulley
4	6700	Crankshaft front oil seal
5	W707288	Accessory drive belt idler pulley bolt
6	19A216	Accessory drive belt idler pulley
7	W714925	Engine front cover bolt (8 required)

8	W704920	Engine front cover bolt (5 required)
9	W704919	Engine front cover stud bolt (2 required)
10	6019	Engine front cover
11	6B297	Variable Camshaft Timing (VCT) variable force solenoid (4 required)
12	6K255	RH timing chain tensioner arm
13	W714258	RH timing chain tensioner arm pin
14	6268	RH primary timing chain
15	6K255	LH timing chain tensioner arm
16	W701501	LH timing chain tensioner arm pin
17	6268	LH primary timing chain
18	6306	Crankshaft sprocket
19	N807352	LH timing chain guide bolt
20	6B274	LH timing chain guide
21	W714258	LH timing chain guide pin
22	N807352	RH timing chain guide bolt
23	6M256	RH timing chain guide
24	W714258	RH timing chain guide pin
25	8566	Coolant bypass tee
26	W713197	Thermostat housing bolt (2 required)
27	8A586	Thermostat housing
28	W503277	Heater outlet tube bolt
29	18663	Heater outlet tube
30	N806282	Coolant pump pulley bolt (4 required)
31	8509	Coolant pump pulley
32	W714925	Coolant pump bolt
33	8501	Coolant pump
34	N806183	Oil pump bolt (2 required)
35	W714252	Oil pump stud bolt
36	W714251	Oil pump stud bolt
37	6600	Oil pump
38	6C315	Crankshaft Position (CKP) sensor
39	W500110	Knock Sensor (KS) bolt (2 required)
40	12A699	<u>KS</u> (2 required)
41	14A411	<u>KS</u> wiring harness
42	6214	Connecting rod cap bolt (16 required)
43	—	Connecting rod cap (part of 6200) (8 required)
44	6211	Connecting rod bearing (16 required)
45	6200	Connecting rod (8 required)
46	6140	Piston pin retainer (16 required)
47	6135	Piston pin (8 required)
48	6110	Piston (8 required)
49	—	Outer oil control ring (part of 6148) (16 required)
50	—	Lower compression ring (part of 6148) (8 required)
51	—	Upper compression ring (part of 6148) (8 required)

52	W714962	Oil pump screen and pickup tube bolt (2 required)
53	6622	Oil pump screen and pickup tube
54	N806180	Oil pump screen and pickup tube spacer
55	N605904	Oil pump screen and pickup tube bolt
56	W714963	Oil pan stud bolt (3 required)
57	6675	Oil pan
58	W714962	Oil pan bolt (13 required)
59	6C878	Oil pan baffle and gasket
60	6345	Crankshaft main bearing cap bolt (9 required)
61	6K258	Crankshaft main bearing cap stud bolt
62	6345	Crankshaft main bearing cap bolt (10 required)
63	—	Crankshaft main bearing cap (part of 6010) (5 required)
64	6D309	Crankshaft lower main bearing
65	6D309	Crankshaft lower main bearing (4 required)
66	N806201	Woodruff key
67	6303	Crankshaft
68	6D309	Crankshaft upper main bearing (5 required)
69	6A341	Thrust washer
70	6K868	Piston cooling jet (4 required)
71	6C358	Crankshaft main bearing cap side bolt (10 required)
72	6010	Engine block
73	6K318	Crankshaft rear seal retainer plate
74	6701	Crankshaft rear seal
75	W714962	Crankshaft rear seal retainer plate bolt (6 required)
76	12A227	Crankshaft sensor ring
77	6375	Flexplate
78	6379	Flexplate bolt (8 required)
79	7120	Input shaft bearing
80	6375	Flywheel
81	6881	Oil filter adapter
82	6890	Oil filter mounting insert bolt
83	6731	Oil filter
84	W714974	Oil filter adapter bolt (2 required)
85	W503306	Oil filter adapter bolt
86	9278	Engine Oil Pressure (EOP) switch

NOTICE: During engine repair procedures, cleanliness is extremely important. Any foreign material, including any material created while cleaning gasket surfaces, that enters the oil passages, coolant passages or the oil pan, can cause engine failure.

NOTICE: During engine assembly do not allow the piston connecting rods to come in contact with the piston cooling jets or engine damage may occur.

NOTE: During engine assembly it may become necessary to check bearing clearances and end play. For additional information, refer to [Section 303-00](#).

1. Record the main bearing code found on the front of the engine block.