

SECTION 309-00 Exhaust System

CONTENTS	PAGE
Exhaust System — Exploded View	309-00-2

Exhaust System — Exploded View

3.7L

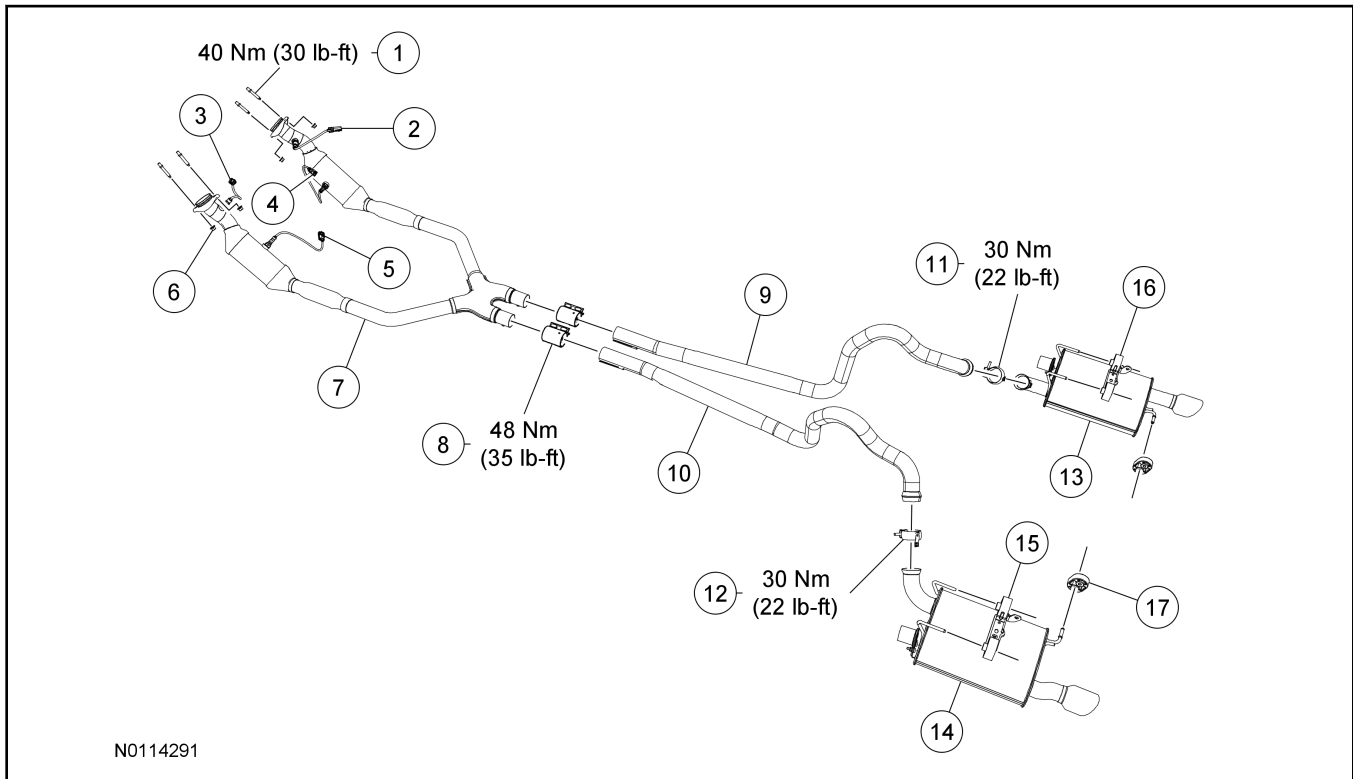

Item	Part Number	Description
1	W705374	Exhaust manifold studs (4 required)
2	—	RH Heated Oxygen Sensor (HO2S) electrical connector (part of 9F472)
3	—	LH HO2S electrical connector (part of 9F472)
4	—	RH Catalyst Monitor Sensor (CMS) electrical connector (part of 9G444)
5	—	LH CMS electrical connector (part of 9G444)
6	W714265	Catalytic converter-to-exhaust manifold nuts (4 required)
7	5F250	Catalytic converter assembly
8	5A281	Torca® coupler (2 required)
9	5A212	RH intermediate pipe
10	5A213	LH intermediate pipe
11	5A231	Ball clamp
12	5A231	Ball clamp
13	5230	RH muffler assembly
14	5232	LH muffler assembly
15	5J267	LH front isolator
16	5A246	RH front isolator
17	5A261	Rear isolator (2 required)

(Continued)

5.0L

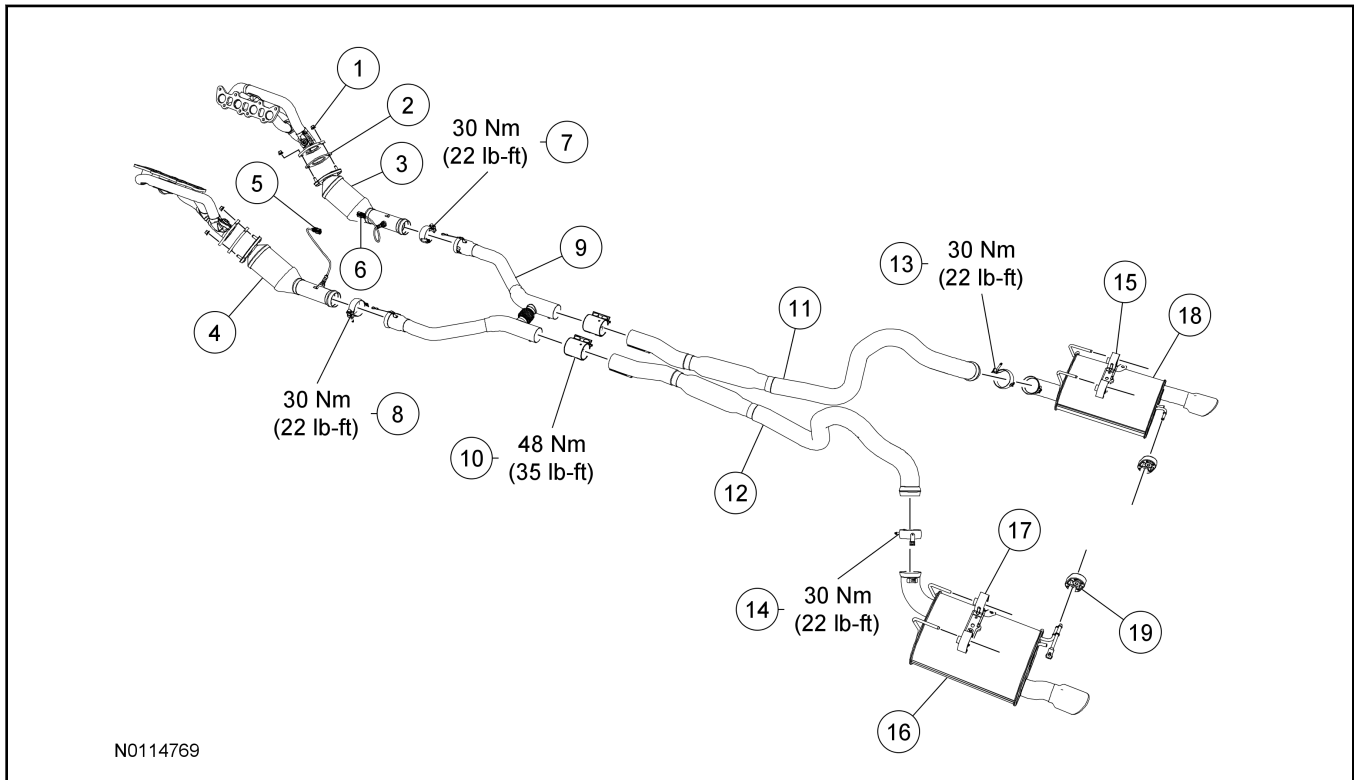

Item	Part Number	Description
1	W714265	Catalytic converter-to-exhaust manifold nuts (4 required)
2	5B266	Gasket (2 required)
3	5E212	RH catalytic converter
4	5E213	LH catalytic converter
5	—	LH CMS electrical connector (part of 9G444)
6	—	RH CMS electrical connector (part of 9G444)
7	—	Ball clamp
8	—	Ball clamp
9	5246	Exhaust H-Pipe
10	5A281	Torca® coupler (2 required)
11	5A212	RH intermediate pipe
12	5A213	LH intermediate pipe
13	5A231	Ball clamp
14	5A231	Ball clamp
15	5A246	RH front isolator
16	5232	LH muffler assembly
17	5J267	LH front isolator
18	5230	RH muffler assembly
19	5A261	Rear isolator (2 required)

(Continued)

Boss® 302 Exhaust H-Pipe

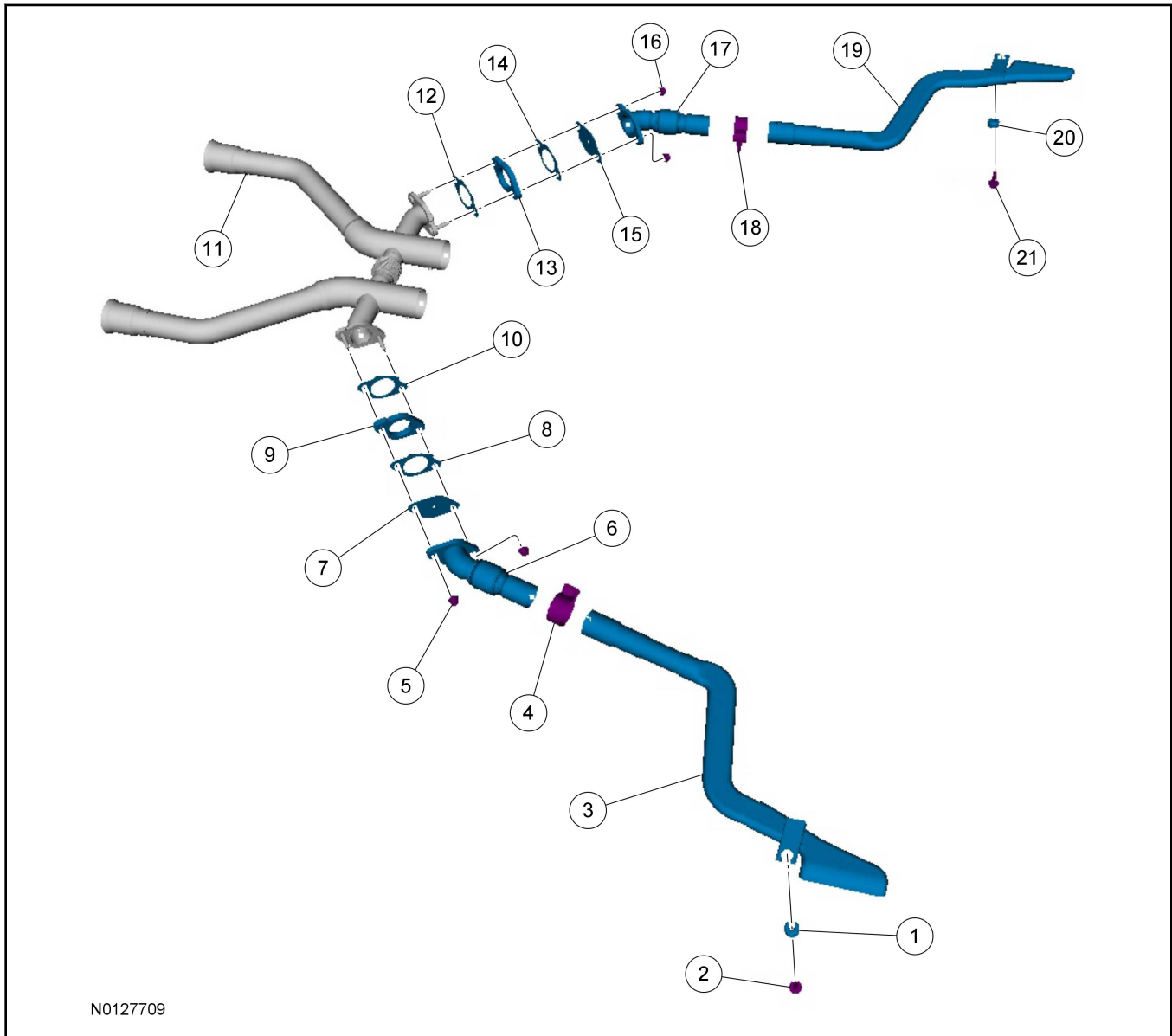

N0127709

Item	Part Number	Description
1	17C431	LH exhaust side pipe grommet assembly
2	W714780	LH exhaust side pipe bolt - 25 Nm (18 lb-ft)
3	5255	LH exhaust side pipe
4	—	LH exhaust side pipe Torca® clamp (part of 5255) - 48 Nm (35 lb-ft)
5	W705443	LH exhaust side pipe-to-exhaust H-pipe nut (2 required) - 40 Nm (30 lb-ft)
6	5255	LH exhaust side pipe flange (part of 5255)
7	5A242	Restrictor
8	5B266	Gasket
9	5H294	Spacer
10	5B266	Gasket
11	5246	Exhaust H-Pipe
12	5B266	Gasket

(Continued)

Item	Part Number	Description
13	5H294	Spacer
14	5B266	Gasket
15	5A242	Restrictor
16	W705443	RH exhaust side pipe-to-exhaust H-pipe nut (2 required) - 40 Nm (30 lb-ft)
17	5255	RH exhaust side pipe flange (part of 5255)
18	—	RH exhaust side pipe Torca® clamp (part of 5255) - 48 Nm (35 lb-ft)
19	5255	RH exhaust side pipe
20	17C431	RH exhaust side pipe grommet assembly
21	W714780	RH exhaust side pipe bolt - 25 Nm (18 lb-ft)

5.4L

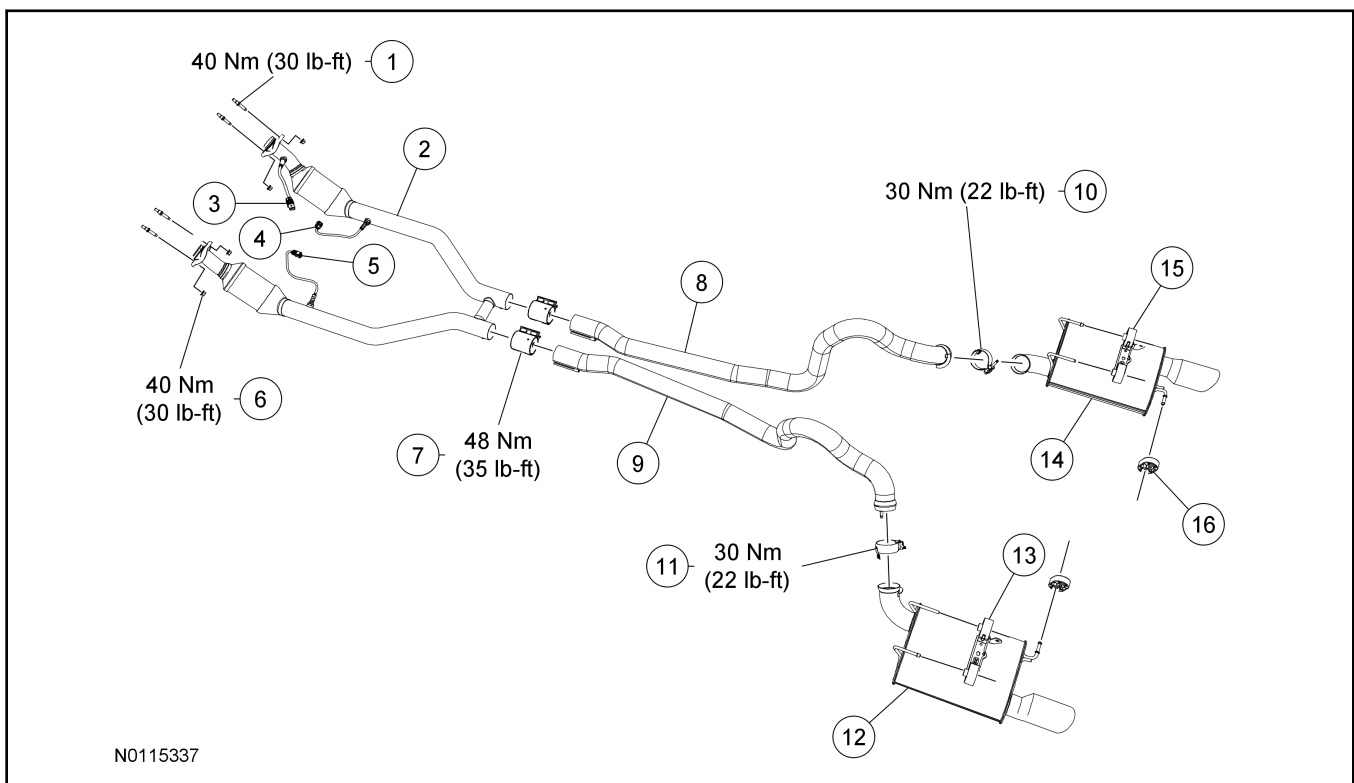

Item	Part Number	Description
1	W705374	Exhaust manifold studs (4 required)
2	5F250	Catalytic converter assembly
3	—	RH HO2S electrical connector (part of 9F472)
4	—	RH CMS electrical connector (part of 9G444)
5	—	LH CMS electrical connector (part of 9G444)
6	W714265	Catalytic converter-to-exhaust manifold nuts (4 required)
7	5A281	Torca® coupler (2 required)
8	5A212	RH intermediate pipe
9	5A213	LH intermediate pipe
10	5A231	Ball clamp
11	5A231	Ball clamp
12	5232	LH muffler assembly
13	5J267	LH front isolator

(Continued)

Item	Part Number	Description
14	5230	RH muffler assembly
15	5A246	RH front isolator
16	5A261	Rear isolator (2 required)

1. Refer to the procedures and/or exploded views in this section for any Warnings, Notices, Notes, Materials, Specifications, and Special Tools. Items in the exploded views may not be listed in order of removal.