

Gearshift Lever

Gearshift Lever Exploded View

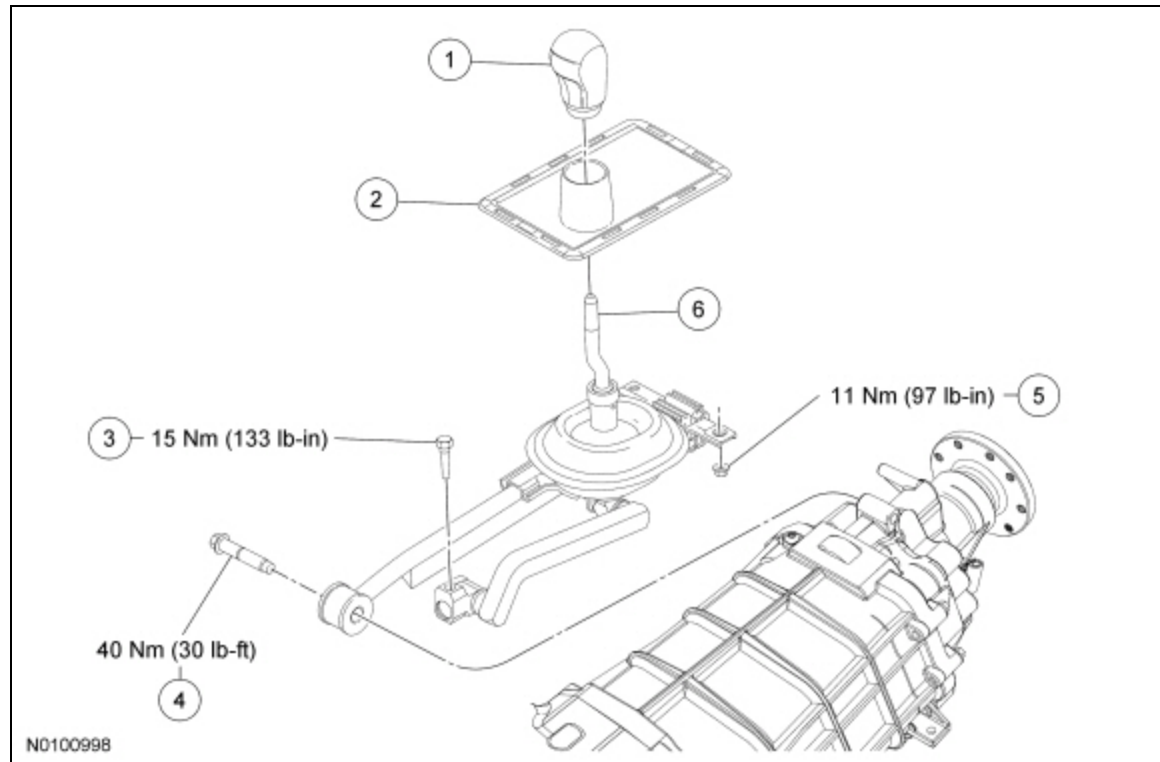

Item	Part Number	Description
1	7213	Gearshift lever knob
2	7B118	Gearshift lever boot
3	7C211	Gearshift lever bolt
4	W71054	Gearshift lever bolt
5	W520101	Gearshift lever nut
6	7210	Gearshift lever assembly

1. Place the gearshift lever in the NEUTRAL position.
2. Remove the gearshift lever knob and boot.
 - Turn the gearshift lever knob in a counterclockwise direction.

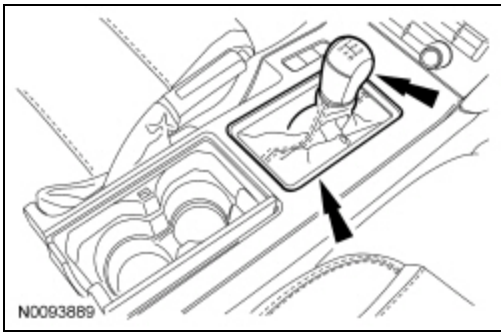

3. With the vehicle in NEUTRAL, position it on a hoist. For additional information, refer to [Section 100-02](#).

4. **NOTE:** Index-mark the driveshaft flange and pinion flange, and the driveshaft flange and transmission output shaft flange.

Remove the driveshaft. For additional information, refer to [Section 205-01](#).

5. Remove the 4 subframe cross brace nuts and the subframe cross brace.

- To install, tighten to 48 Nm (35 lb-ft).

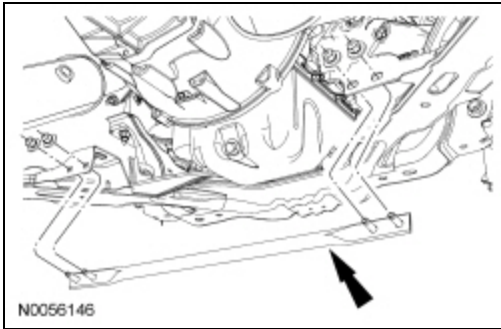

6. Using a suitable transmission jack, support the transmission.

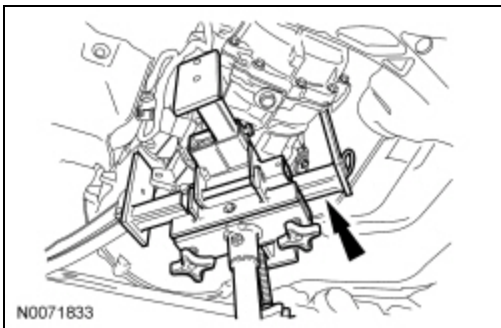

7. Remove the 4 transmission crossmember bolts.

- To install, tighten to 63 Nm (46 lb-ft).

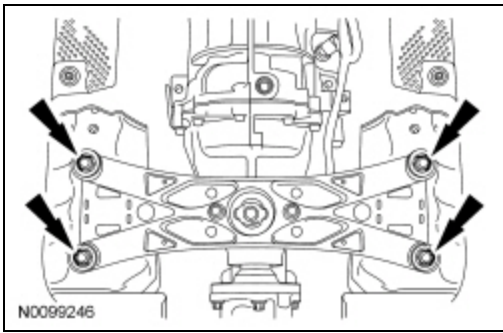

8. Lower the transmission.

9. Remove the 2 rear gearshift lever nuts.
- To install, tighten to 11 Nm (97 lb-in).

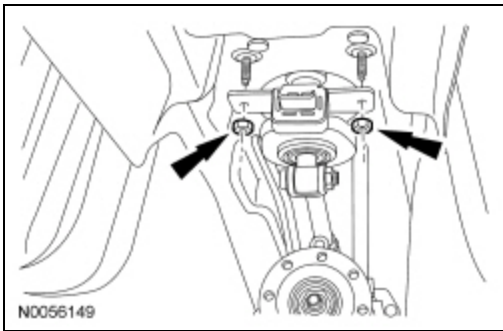

10. Remove the gearshift lever assembly bolts and the gearshift assembly.
1. To install, tighten to 40 Nm (30 lb-ft).
 2. To install, tighten to 15 Nm (133 lb-in).

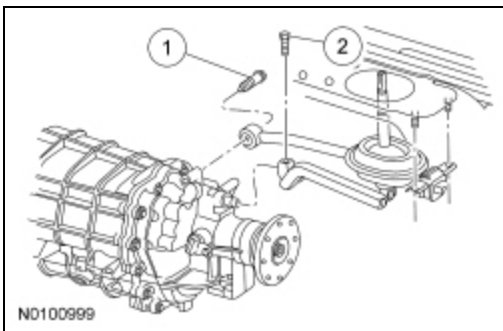

11. To install, reverse the removal procedure.

