

Steering Column

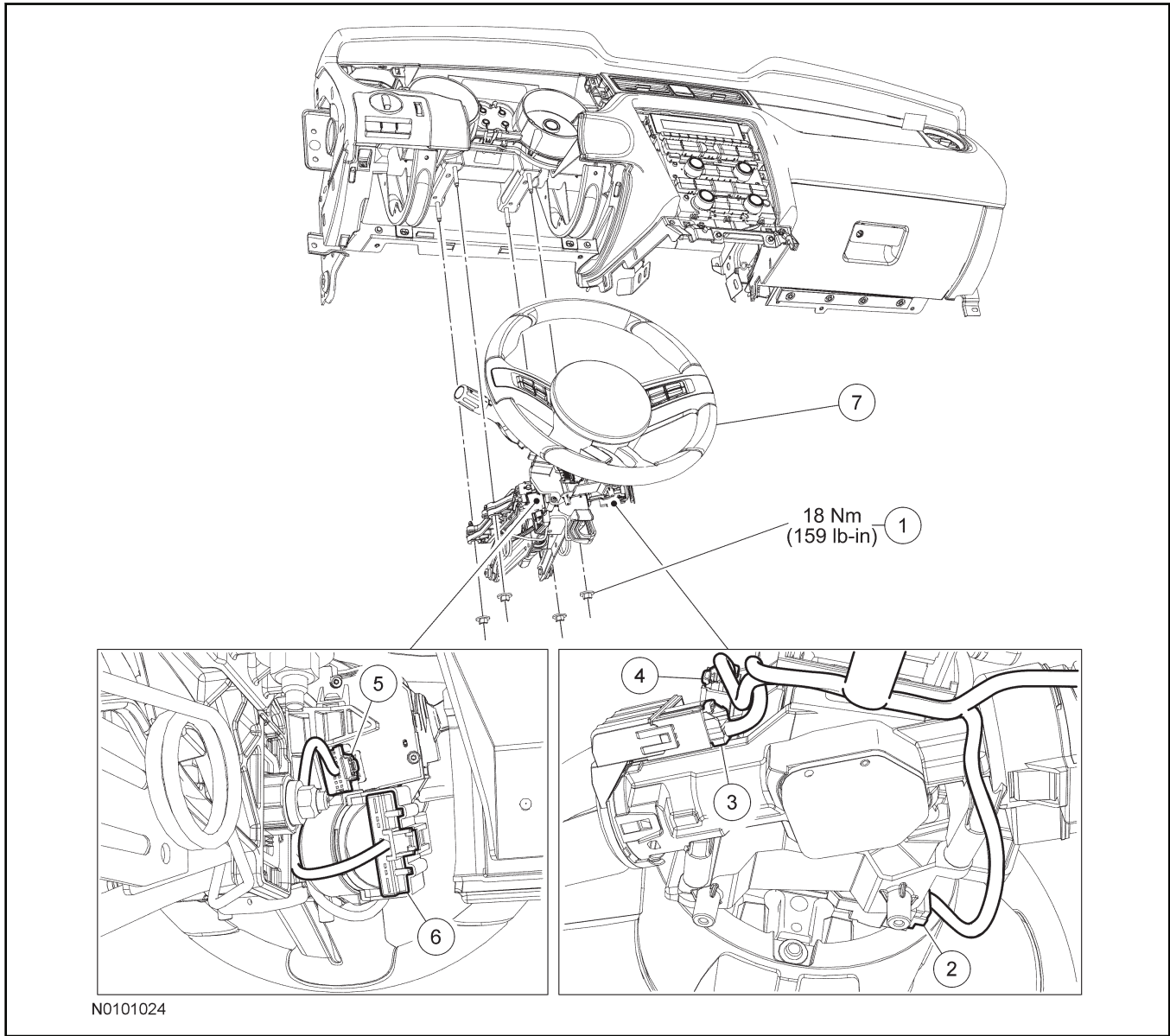

N0101024

Item	Part Number	Description
1	W705047	Steering column nut (4 required)
2	—	Clockspring electrical connector (part of 14401)
3	—	Passive Anti-Theft System (PATS) electrical connector (part of 14401)
4	—	Steering wheel rotation sensor
5	—	Multifunction switch electrical connector (part of 14401)
6	—	Ignition switch electrical connector (part of 14401)
7	3C529	Steering column

Removal and Installation

1. Depower the Supplemental Restraint System (SRS). For additional information, refer to Section 501-20B.
2. Place the steering wheel in the straight-ahead position and remove the ignition key.
3. Remove the steering column shrouds. For additional information, refer to Steering Column Shroud in this section.
4. Disconnect the electrical harness pin-type retainers.

---

**(Continued)**

5. Disconnect the following electrical connectors:

- Ignition switch
- Multifunction switch
- Clockspring
- Passive Anti-Theft System (PATS)
- Steering wheel rotation sensor

6. **NOTICE:**

**Do not allow the steering column to rotate while the steering column shaft is disconnected or damage to the clockspring may result. If there is evidence that the steering column shaft has rotated, the clockspring must be removed and recentered. For additional information, refer to Section 501-20B.**

Remove and discard the steering column shaft-to-steering column bolt and disconnect the shaft from the steering column.

- To install, tighten the new bolt to 25 Nm (18 lb-ft).

7. Remove the 4 nuts and the steering column.

- To install, tighten to 18 Nm (159 lb-in).

8. To install, reverse the removal procedure.