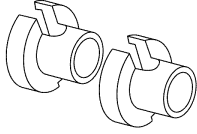

SECTION 310-00 Fuel System — General Information

CONTENTS	PAGE
GENERAL PROCEDURES	
Spring Lock Couplings	310-00-2

GENERAL PROCEDURES**Spring Lock Couplings****Special Tool(s)**

 <p>ST1399-A</p>	<p>Spring Lock Coupling Disconnect Tool 310-S039 (T90T-9550-S) or equivalent</p>
---	--

Material

Item	Specification
Motorcraft® SAE 5W-20 Premium Synthetic Blend Motor Oil (US); Motorcraft® SAE 5W-20 Super Premium Motor Oil (Canada) XO-5W20-QSP (US); CXO-5W20-LSP12 (Canada)	WSS-M2C945-A

Disconnect**⚠ WARNING:**

Do not smoke, carry lighted tobacco or have an open flame of any type when working on or near any fuel-related component. Highly flammable mixtures are always present and may be ignited. Failure to follow these instructions may result in serious personal injury.

⚠ WARNING:

Do not carry personal electronic devices such as cell phones, pagers or audio equipment of any type when working on or near any fuel-related component. Highly flammable mixtures are always present and may be ignited. Failure to follow these instructions may result in serious personal injury.

⚠ WARNING:

Before working on or disconnecting any of the fuel tubes or fuel system components, relieve the fuel system pressure to prevent accidental spraying of fuel. Fuel in the fuel system remains under high pressure, even when the engine is not running. Failure to follow this instruction may result in serious personal injury.

⚠ WARNING:

When handling fuel, always observe fuel handling precautions and be prepared in the event of fuel spillage. Spilled fuel may be ignited by hot vehicle components or other ignition sources. Failure to follow these instructions may result in serious personal injury.

⚠ WARNING:

Always disconnect the battery ground cable at the battery when working on an evaporative emission (EVAP) system or fuel-related component. Highly flammable mixtures are always present and may be ignited. Failure to follow these instructions may result in serious personal injury.

NOTICE:

When reusing liquid or vapor tube connectors, make sure to use compressed air to remove any foreign material from the connector retaining clip area before separating from the tube or damage to the tube or connector retaining clip can occur. Apply clean engine oil to the end of the tube before inserting the tube into the connector.

NOTICE:

Fuel injection equipment is manufactured to very precise tolerances and fine clearances. It is essential that absolute cleanliness is observed when working with these components or component damage can occur. Always install blanking plugs to any open orifices or tubes.

1. If servicing a liquid fuel tube spring lock coupling, release the fuel system pressure. For additional information, refer to Fuel System Pressure Release in this section.
2. Disconnect the battery ground cable. For additional information, refer to Section 414-01.
3. If equipped, remove the fuel tube safety clip.

GENERAL PROCEDURES (Continued)

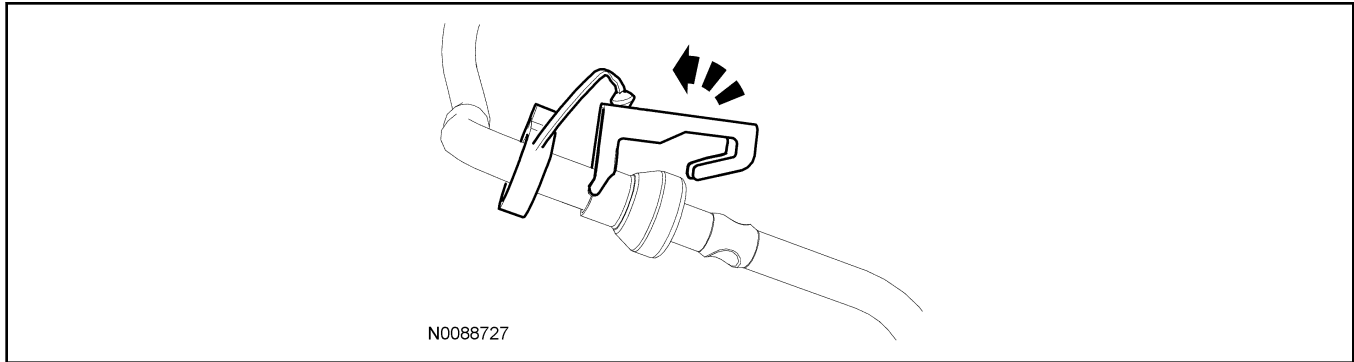

4. Install the Spring Lock Coupling Disconnect Tool on the tube and push into the spring lock coupling to release.

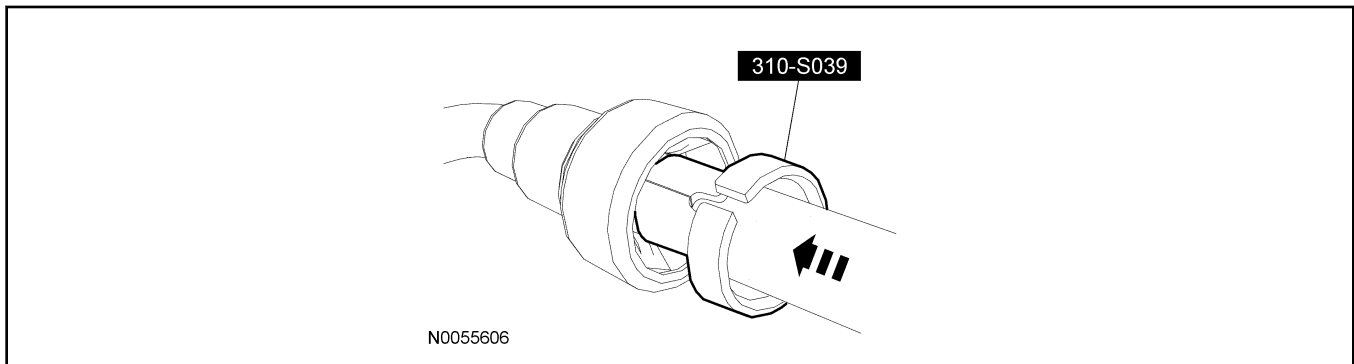

5. Separate the spring lock coupling from the tube fitting.

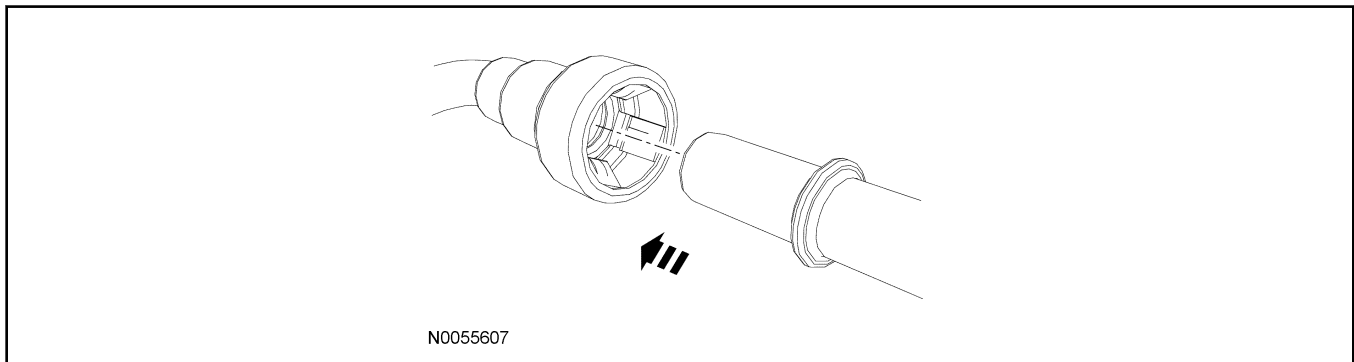
**Connect**

1. **NOTE:**
Lubricate the tube fitting with clean engine oil.

Align and push the spring lock coupling onto the tube fitting until fully seated.

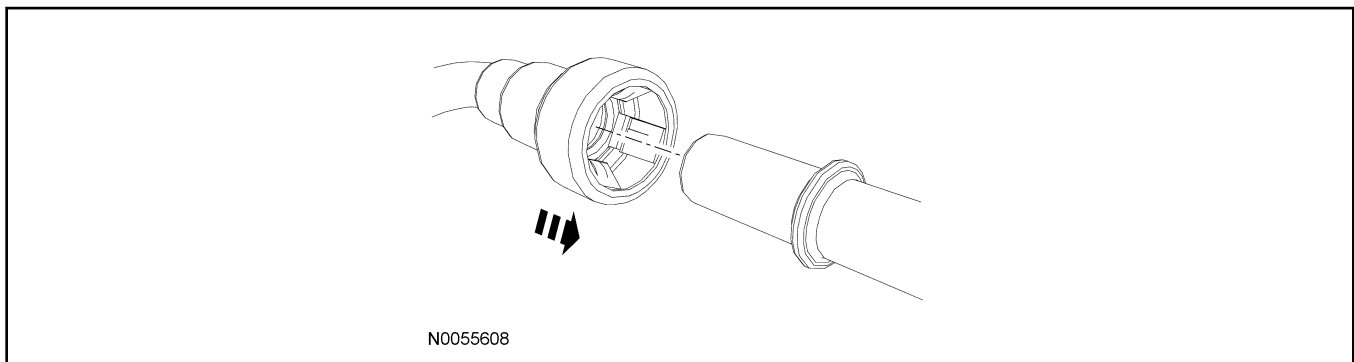

2. Pull on the coupling to make sure it is fully engaged.

GENERAL PROCEDURES (Continued)

3. If equipped, install the fuel tube safety clip.

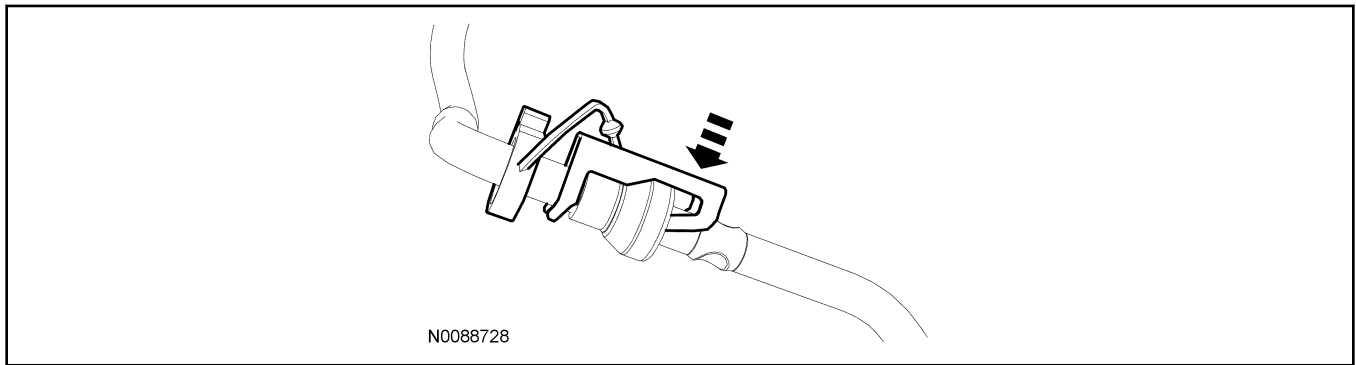

4. Connect the battery ground cable. For additional information, refer to Section 414-01.