



FDMUS05

INSTALLATION INSTRUCTIONS

---

---

## 2005 FORD MUSTANG SUBWOOFER ENCLOSURE

---

---

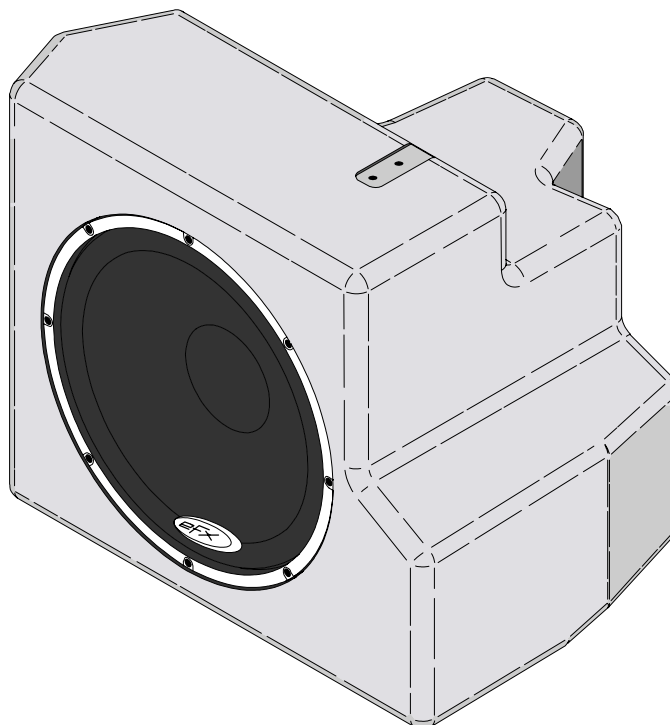

### **Features:**

- 12" EFX Polypropylene Subwoofer
- Custom Fit, Space-saving Design
- Mounting Hardware Included
- Impedance: 4 Ohm
- Non-Amplified, Sealed Enclosure
- Custom Grille Designed to Complement Vehicle Aesthetics
- Power Handling: 300W RMS / 900W Max
- High-Impact Polyethylene Material
- Uses Factory Mounting Points
- Factory Matched Color Carpet
- Nickel-Plated Speaker Terminals

### **Mounting Location:**

- Rear Right Corner of Trunk

### **Applications:**

- ALL 2005-UP Ford Mustang models including: V6/V8/GT/Deluxe/Premium\*  
(\*Shaker 1000 system requires Factory Sub enclosure removal)

### **Tools Required for Installation:**

- Phillips Screwdriver
- Adjustable Wrench
- Punch or Pick Tool

If you have any further questions, call our toll free technical help line at: **1-800-621-3695x3**

## PARTS LIST

- (1) Top “L” Bracket
- (2) 8mm x 25mm Hex Bolts
- (2) Lock Washers
- (1) Bottom Flat Bracket
- (4) 3mm x 16mm Phillips Screws
- (2) Wing Nuts (Used for Shaker 1000 only)

## ATTACHING BRACKETS

Assemble the enclosure mounting brackets as shown in Figure 1.

1. The “L” bracket mounts to the top of the enclosure. Use a Phillips head screwdriver and (2) supplied 3mm x 16mm Screws to fasten the bracket. Threaded fittings are molded into the surface of the enclosure for easy installation. (See Figure 1)
2. The “Flat” bracket mounts to the bottom side of the enclosure. Use the (2) remaining 3mm x 16mm Screws to fasten the bracket. (See Figure 1)

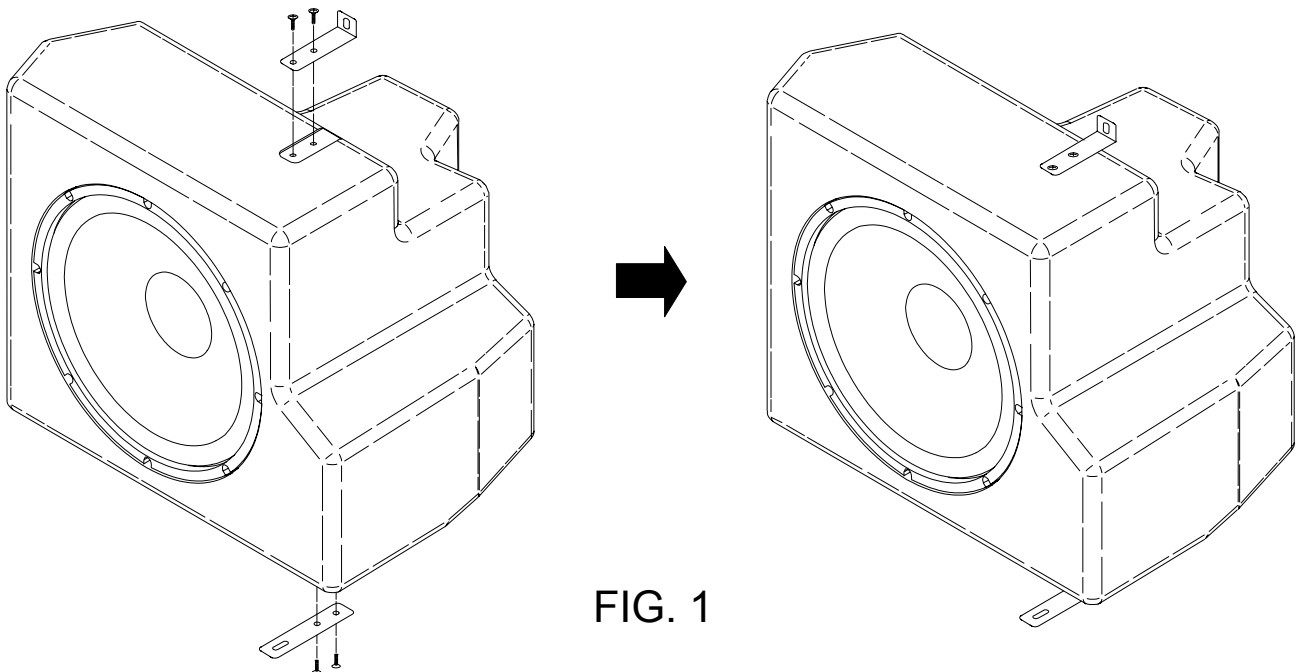

## ENCLOSURE INSTALLATION

**NOTE:** If the vehicle is equipped with a "Shaker1000" Ford Mach Sound System, the Factory Subwoofer /Amp Rack assembly must be removed. See next section: "Mach Audio Shaker 1000 Removal / Installation".

### PREPARING THE MOUNTING POINTS:

1. Pull back liner material from bottom right corner of the trunk.
2. Remove the round protective seal (sticker pad) near the spare tire well to reveal the Factory threaded screw hole.
3. Reposition the trunk liner and use a punch or pick tool to punch through the liner material over bolt hole location.
4. Pop out the carpet fastener from the top right rear corner of the trunk area. Removal of this popper will reveal the top threaded mounting hole.

### ENCLOSURE INSTALLATION:

1. Once the mounting points are ready, place the sub enclosure on the trunk floor and connect the speaker wire from your Sub Amplifier. (RED Terminal = Subwoofer Positive, BLACK Terminal= Subwoofer Negative)
2. Position the sub enclosure into the rear right corner of the trunk aligning the holes in the brackets with the factory bolt hole locations.
3. Use the (2) supplied 8x25mm bolts and lock washers to secure the sub enclosure to the vehicle. (See Figure 2)

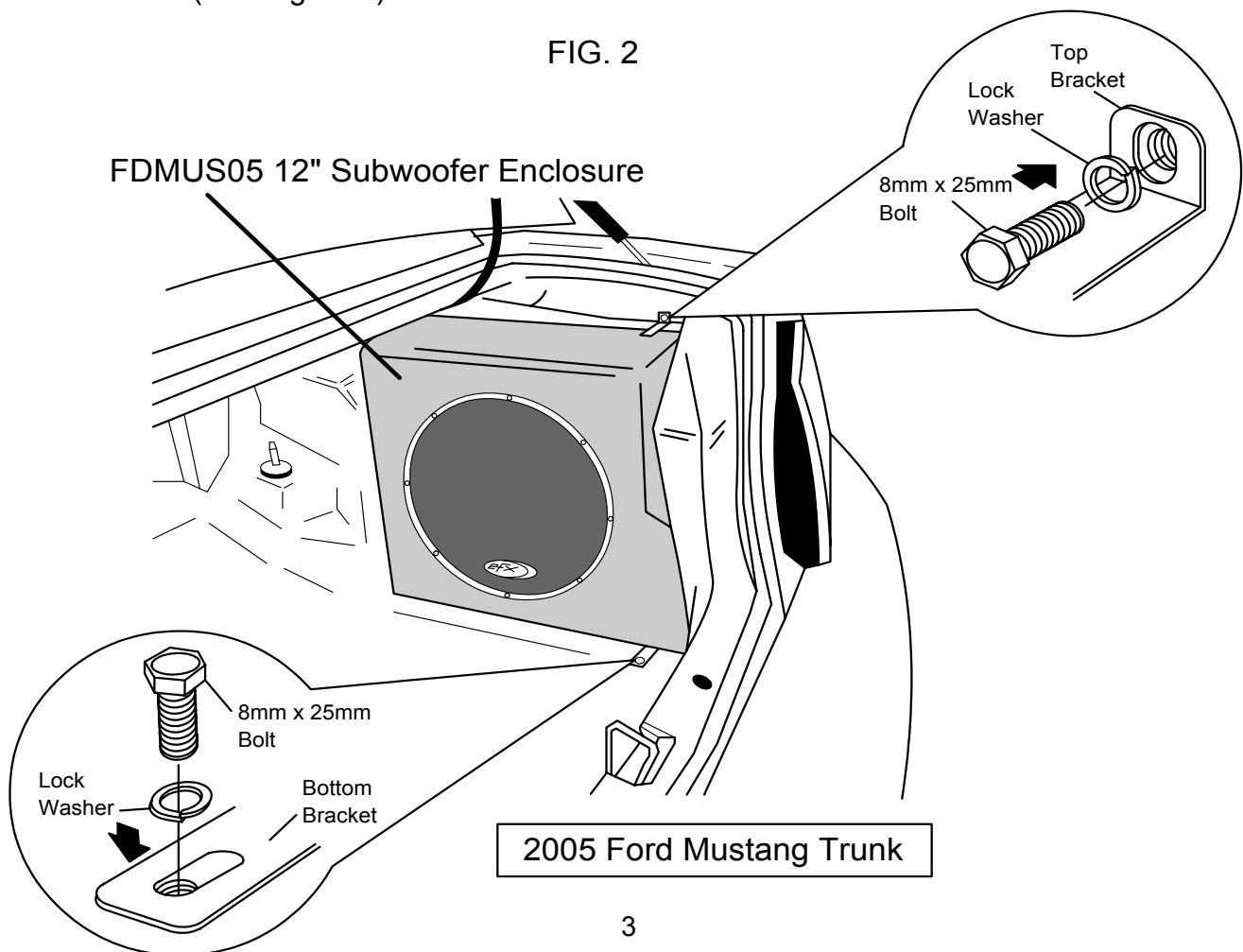

## MACH AUDIO (SHAKER 1000) REMOVAL / INSTALLATION

### ENCLOSURE REMOVAL / INSTALLATION:

1. Using an adjustable wrench, remove 3 retaining nuts located near the front, top and rear of the MACH Audio Sub enclosure/amp rack.
2. Unplug and remove the entire assembly.
3. Leave the top and rear Factory Ford mounting studs in place as these will be used to fasten the EFX enclosure.
4. Use the lock washers and wing nuts provided to mount the sub enclosure to the Ford studs. (See Figure 3)

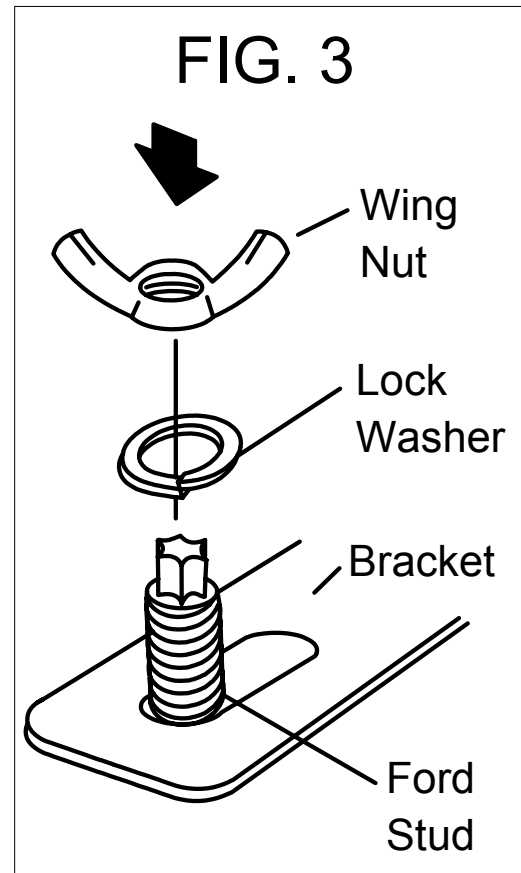

#### LIMITED WARRANTY

Scosche Industries Inc. warrants this product to be free from defects in material and workmanship, for a period of 1 year from purchase. This Scosche product is sold with the understanding that the purchaser has independently determined the suitability of this product. This warranty DOES NOT cover any expenses incurred from the installation, removal, or re-installation of this product incidental or otherwise. This warranty is offered to the original purchaser of the product only. This warranty does not cover the product if physically damaged, subjected to negligence or misuse, abuse, improper installation, alteration, accident, connection to improper WATTAGE amounts, or an act of God. Also excluded from this warranty are costs for the correction of faulty installation, and elimination of electromagnetic interference. (Engine noise) The original dated sales slip or proof of purchase will establish warranty eligibility. If the product should prove defective, within the warranty period, return the product with proof of purchase to Scosche Industries, Inc. Scosche at its option, will replace or repair the product free of charge, and return the product postage-paid. In no event shall Scosche Industries, Inc. be responsible for claims beyond the replacement value of the defective product, or in any way be liable or responsible for consequential or incidental damages. No express warranties and no implied warranties whether for fitness or any particular use, or otherwise, except as set forth above (which is made expressly in lieu of all other warranties) shall apply to products. Scosche industries can not be held responsible for discrepancies/inconsistencies that may occur, due to automotive manufacturing changes or options.