

Seat Backrest — Front

Disassembly

⚠ WARNING: Always carry a live airbag with the deployment door, trim cover or tear seam pointed away from the body. Do not place a live airbag down with the deployment door, trim cover or tear seam facing down. Failure to follow these instructions may result in serious personal injury in the event of an accidental deployment.

NOTICE: Do not reinstall any heater mat or foam pad after removal. The adhesive will not adhere correctly to the foam pad, causing it to bunch up or shift out of place. A new heater mat and a new foam pad must be installed. Failure to follow these instructions can result in heated seat component damage and system failure.

NOTE: If a side air bag deployment took place, install a new seat backrest foam pad, cover, side air bag module, bracket, nuts, U-nuts, bolts and seat backrest frame (if necessary).

NOTE: For parts identification and location, refer to [Seat — Exploded View, Front](#)



Side Airbag

NOTE: Low back shown, high back similar.

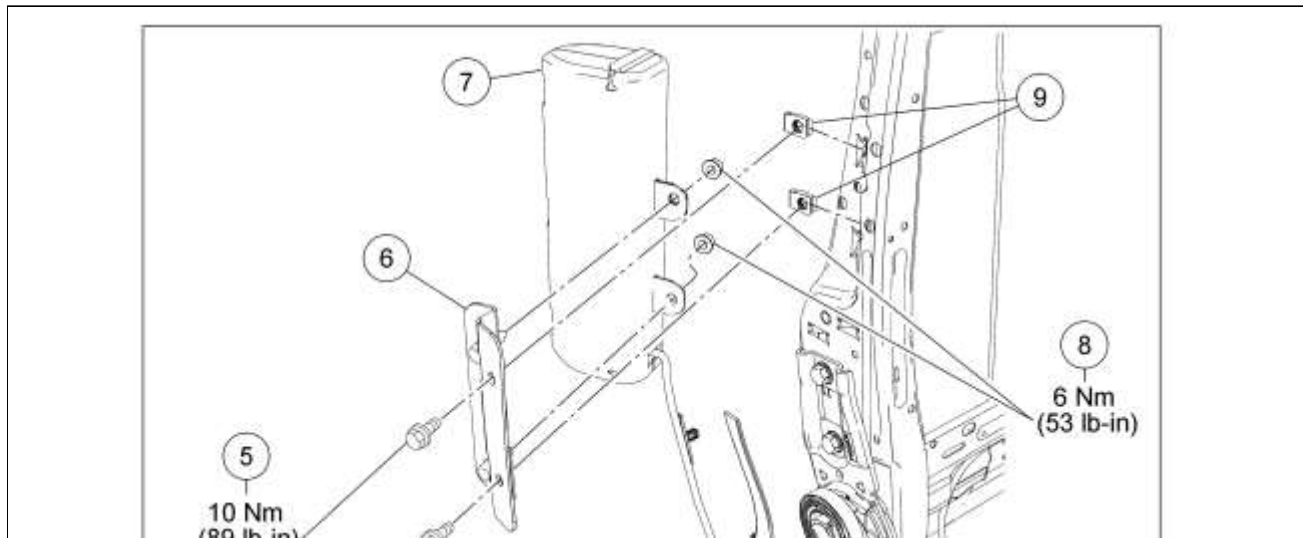

NOTE: Manual seat shown, power similar in this section.

1. Remove the seat backrest cover. For additional information, refer to [Seat Backrest Cover — Front](#) in this section.
2. Remove the backrest foam pad from the backrest frame.
3. **NOTICE:** Note the position of the wiring harness for correct installation. An incorrectly routed wiring harness can be damaged when the seat is moved.

Remove the side air bag module.

- Release the side air bag module wire harness pin-type retainers from the backrest frame.
- Remove the 2 side air bag module bolts.
- Remove the side air bag module with bracket and wire harness.
- If installing a new side air bag module, remove and discard the 2 U-nuts from the backrest frame.

4. **NOTE:** Note the cable routing for correct installation.

Detach the backrest latch release cable from the outboard recliner and cable clamp.

5. Remove the 2 rivets, pull out at the bottom and remove the backrest latch release.
6. Detach the 4 hooks from the backrest frame and remove the lumbar assembly.
 - If equipped, disconnect the power lumbar electrical connector.

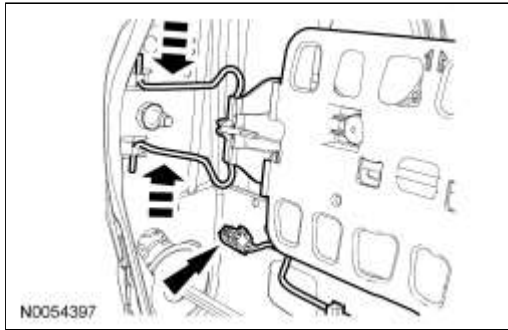

Assembly

1. Attach the 4 hooks and install the lumbar assembly to the backrest frame.
 - If equipped, connect the power lumbar electrical connector.
2. Install the backrest latch release and 2 rivets.
 - If necessary, install a tie strap, holding the cable to the backrest frame.
3. Route the backrest latch release cable as noted during disassembly and install the cable and casing to the outboard recliner.
4. **NOTE:** *When installing a new side air bag module after deployment, install a new side air bag module, bracket, module-to-bracket nuts, U-nuts-to-backrest frame and side air bag module bracket-to-seat backrest frame bolts.*

For seats receiving a new side air bag module, install 2 new U-nuts to the backrest frame, install a new bracket to the side air bag module and 2 nuts.

- Tighten the nuts to 6 Nm (53 lb-in).

5. **WARNING:** **Inspect the seat side air bag module and mounting surfaces for any damage or foreign material before installing the seat side air bag module. If any damage is found, install new components. If any foreign material is found, remove it. Failure to follow these instructions may result in the seat side air bag module deploying incorrectly and increase the risk of serious personal injury or death in a crash.**

WARNING: **If the seat side airbag cover has been damaged or separated from its mounting, or if the airbag material has been exposed, install a new seat side airbag assembly. Never try to repair the seat side airbag assembly. Failure to follow these instructions may result in the seat side airbag deploying incorrectly, which increases the risk of serious personal injury or death in a crash.**

NOTICE: **To avoid component damage, make sure the side air bag module wiring harness is not pinched between the side air bag module and the mounting bracket.**

Install the side air bag module and 2 bolts to the backrest frame.

- Tighten to 10 Nm (89 lb-in).
- Attach the wiring pin-type retainers to the seat backrest frame.

6. Install the backrest foam pad.
7. Install the seat backrest cover. For additional information, refer to [Seat Backrest Cover — Front](#) in this section.

