

# REMOVAL AND INSTALLATION

## Lower Arm

4.0L and 4.6L shown, 5.4L similar

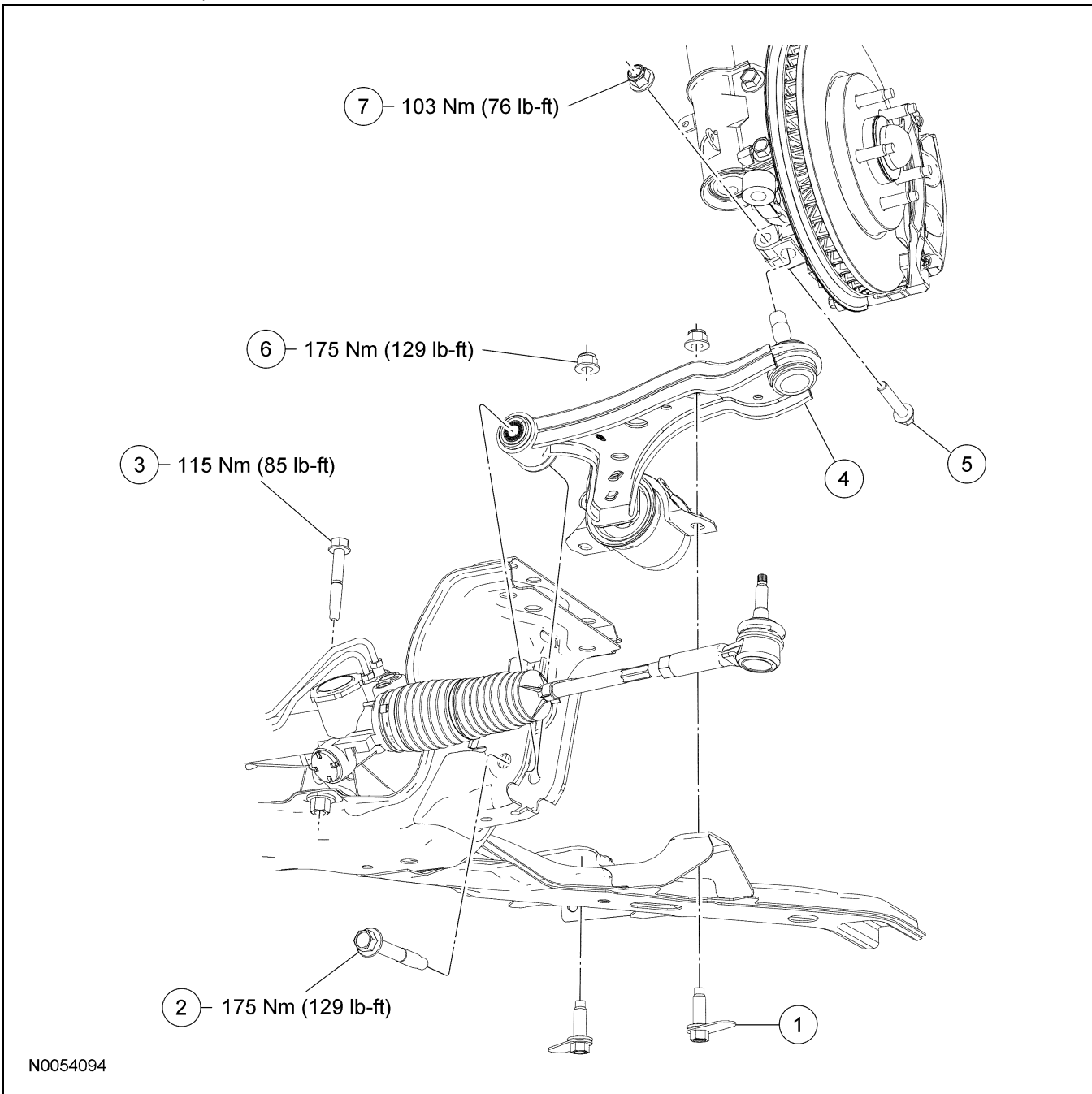

N0054094



Item	Part Number	Description
1	W710141	Lower control arm rearward flag bolt (2 required)
2	W709865	Lower control arm forward bolt
3	W710909	Steering gear bolt (2 required)

(Continued)

Item	Part Number	Description
4	3A053 LH/ 3A052 RH	Lower control arm
5	W711123	Lower ball joint bolt
6	W520215	Lower control arm rearward nut (2 required)
7	W520214	Lower ball joint nut

**REMOVAL AND INSTALLATION (Continued)****Removal and Installation**

 **CAUTION:** Suspension fasteners are critical parts because they affect performance of vital components and systems and their failure can result in major service expense. A new part with the same part number or an equivalent part must be installed, if installation is necessary. Do not use a part of lesser quality or substitute design. Torque values must be used as specified during reassembly to make sure of correct retention of these parts.

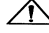
1. With the vehicle in NEUTRAL, position it on a hoist. For additional information, refer to Section 100-02.
2.  **CAUTION:** Note the orientation of the lower ball joint nut and bolt. They must be installed using the same orientation.  
Remove the lower ball joint nut and bolt.
  - To install, tighten the nut to 103 Nm (76 lb-ft).
3. Separate the lower control arm and the wheel spindle.
4. Remove the steering gear bolts. Position the steering gear to gain access to the lower control arm forward bolt.
  - To install, tighten to 115 Nm (85 lb-ft).
5.  **CAUTION:** Do not damage the steering gear boot while removing or installing the lower control arm forward bolt.  
Remove the lower control arm forward nut and bolt.
  - To install, tighten to 175 Nm (129 lb-ft).
6. **NOTE:** To ease installation, the position of the lower control arm nut and flag bolt can be reversed to allow installation of the nut from underneath the vehicle.  
Remove the lower control arm rearward nuts and flag bolts.
  - To install, tighten to 175 Nm (129 lb-ft).
7. Remove the lower control arm and bracket assembly.
8. Remove the 3 heat shield bolts.
  - To install, tighten to 7 Nm (62 lb-in).
9. Remove the heat shield.
10.  **CAUTION:** Tighten the lower control arm and lower ball joint nuts with the suspension at curb height.  
 **CAUTION:** The lower ball joint seal must be fully seated against the knuckle or premature damage to the ball joint can occur.  
To install, reverse the removal procedure.