

REMOVAL AND INSTALLATION

Disc Brake System — Exploded View

NOTE: LH shown, RH similar.

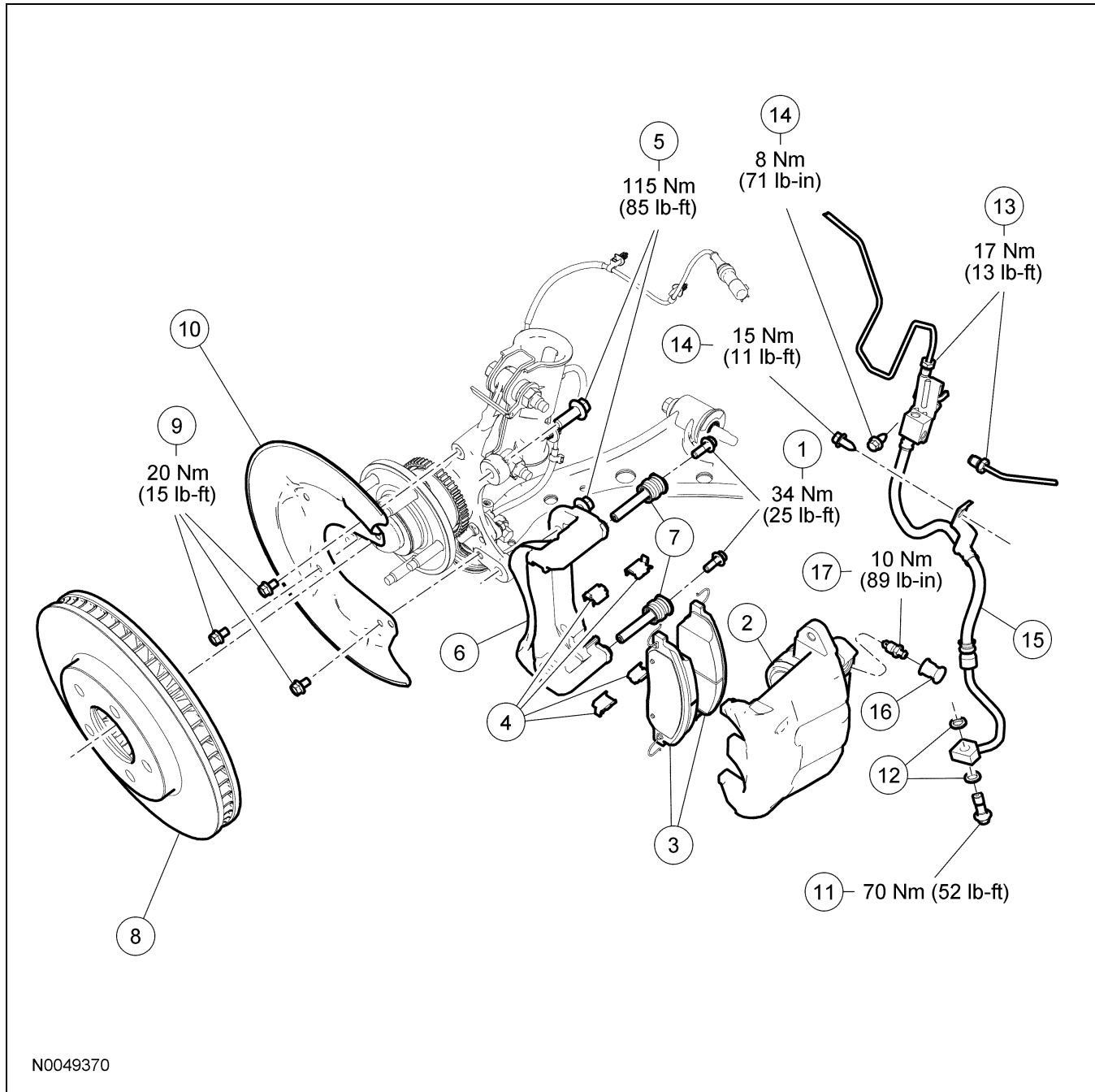

N0049370

Item	Part Number	Description
1	—	Brake caliper bolts (2 required) (part of 2B134)
2	2C357 RH/ 2C358 LH	Brake caliper
3	2001	Brake pads kit
4	2W180	Spring clips (4 required)

(Continued)

Item	Part Number	Description
5	W7095872-S439	Brake caliper anchor plate bolts (2 required)
6	2B134	Brake caliper anchor plate
7	—	Guide pins (part of 2B134)
8	1125	Brake disc

(Continued)

REMOVAL AND INSTALLATION (Continued)

Item	Part Number	Description
9	—	Brake disc shield bolts (3 required)
10	2K004	Brake disc shield
11	W709298-S901	Brake caliper flow bolt
12	388949	Copper washers (2 required)
13	—	Brake tube fittings
14	W704911-S439	Brake flexible hose bracket bolts (part of 2078/2B557)
15	2078 RH/ 2B557 LH	Brake flexible hose
16	—	Bleeder screw cap (part of 2208)

(Continued)

Item	Part Number	Description
17	2208	Bleeder screw

- NOTE:** A revised part, with the same base part number, has been released for the RH brake hose. When installing a new RH brake hose, position the anti-rotation tab on the mounting bracket toward the front of the vehicle and install the bolt with the head toward the rear of the vehicle.

For additional information, refer to the procedures in this section.