

REMOVAL AND INSTALLATION

Stabilizer Bar

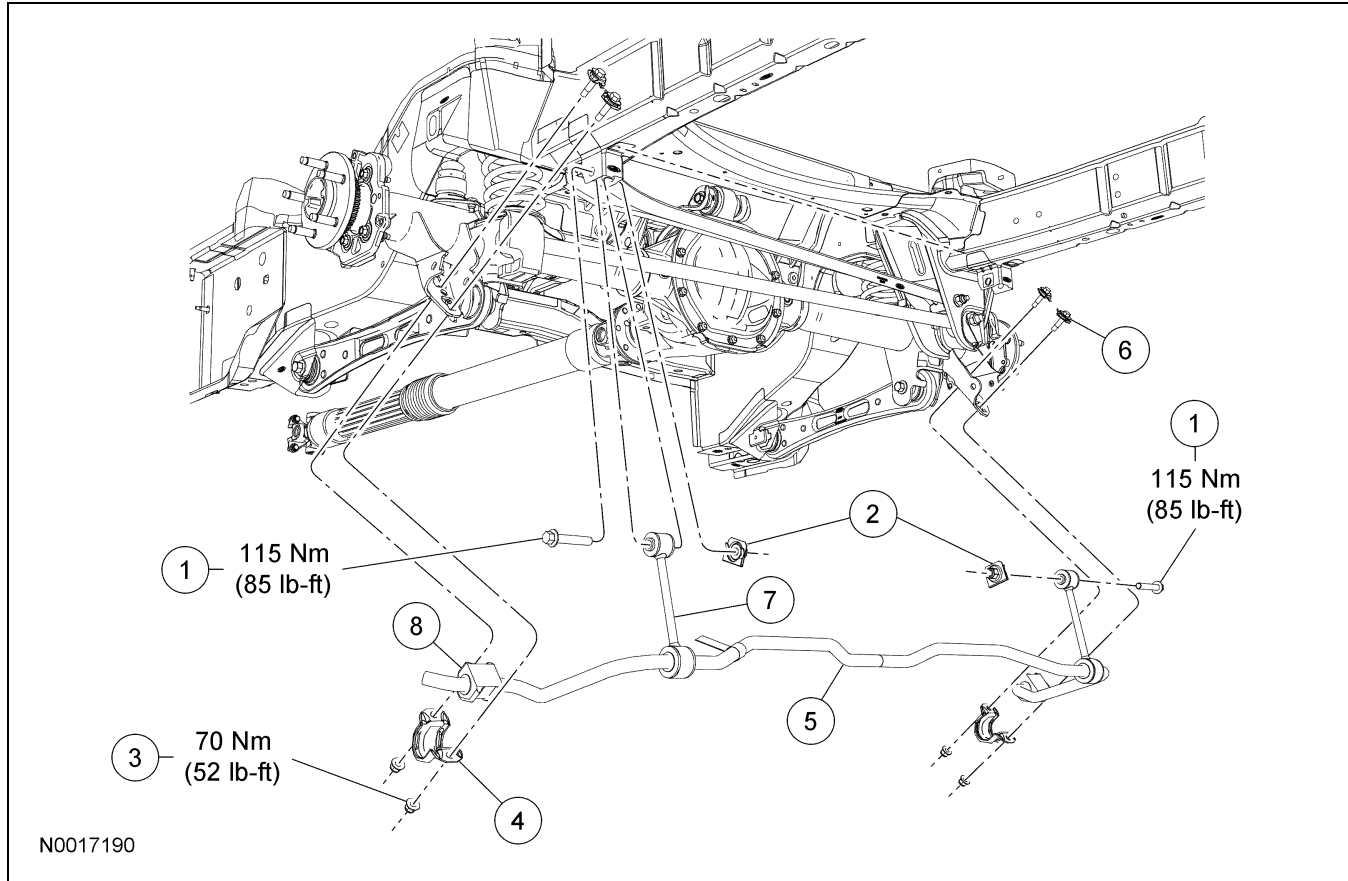

Item	Part Number	Description
1	W708737	Stabilizer bar link bolts (2 required)
2	W711029	Stabilizer bar link clip nuts (2 required)
3	W520213	Stabilizer bar bracket nut (4 required)
4	5486	Stabilizer bar bracket (2 required)
5	5A771	Stabilizer bar
6	W711368	Stabilizer bar bracket clip stud (4 required)
7	5C488	Stabilizer bar link (2 required) (also part of 5A771)
8	4A037	Stabilizer bar bushing (2 required) (also part of 5A771)

Removal and Installation

⚠ CAUTION: Suspension fasteners are critical parts because they affect performance of vital parts and systems and their failure can result in major service expense. A new part with the same part number must be installed if installation becomes necessary. Torque values must be used as specified during reassembly to make sure of correct retention of these parts.

1. With the vehicle in NEUTRAL, position it on a hoist. For additional information, refer to Section 100-02.
2. Remove and discard the stabilizer bar link bolts and clip nuts.
 - To install, tighten to 115 Nm (85 lb-ft).

REMOVAL AND INSTALLATION (Continued)

3. Remove the stabilizer bar bracket nuts, studs, brackets and stabilizer bar.
 - Discard the stabilizer bar bracket nuts and studs.
 - To install, tighten to 70 Nm (52 lb-ft).
4. If necessary, remove the stabilizer bar bushings and links. For additional information, refer to Stabilizer Bar Link in this section.

5.  **CAUTION: The stabilizer bar is equipped with a tag. This tag indicates the LH side of the stabilizer bar. When installing a new stabilizer bar, make sure the tag is on the LH side of the vehicle.**

NOTE: The stabilizer bar is vehicle specific (convertible and coupe). Make sure the correct stabilizer bar goes on the correct vehicle.

The stabilizer bar for the convertible will have a “B” suffix in the part number and it will have a green-colored tag. The stabilizer bar for the coupe will have an “A” suffix in the part number and it will have a yellow-colored tag.

To install, reverse the removal procedure.
